

Online Catalogue



www.kakuta.eu

KAKUTA



RELEASE - **LOCK**TM

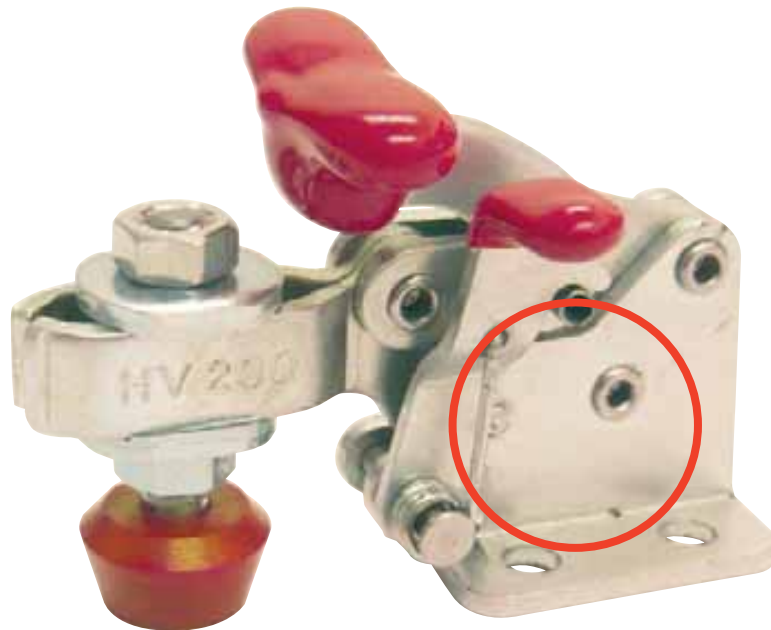

Neue Modelle mit SICHERHEITSVERRIEGELUNG					
Release lock Models					
HH	300	RL	FA	200	RL
HH	400	RL	FA	300	RL
HH	500	RL	FA	400	RL
HH	600	RL			
HH	350	RL			
HH	450	RL			
HH	55	RL			
		RL			
HV	200	RL	SI	310	RL
HV	300	RL	SL	350	RL
HV	400	RL			



Seit 1938 steht der Name KAKUTA für hochwertige und innovative, japanische Spannelemente.

Unsere Erfahrung und unser Wissen, das wir uns seit 1938 in der Herstellung von Spannelementen angeeignet haben, hilft uns auch in Zukunft unsere Produkte an der Praxis auszurichten.

Wir bieten Ihnen hochwertige und preisgünstige Spanntechnik:

- Vertikalspanner
- Horizontalspanner
- Schubstangenspanner
- Verschlussspanner
- Spannzangen

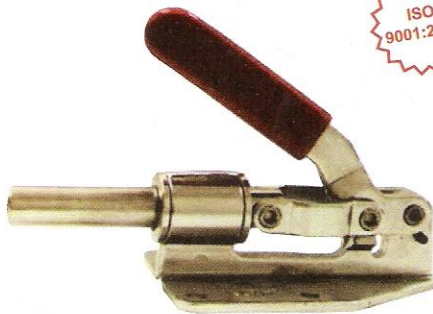
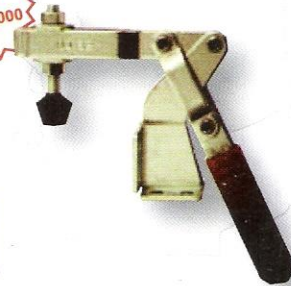
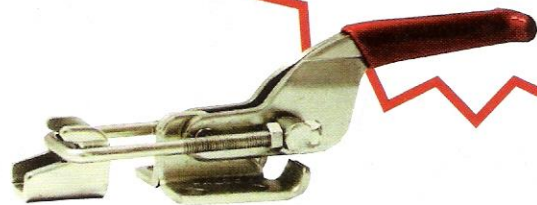
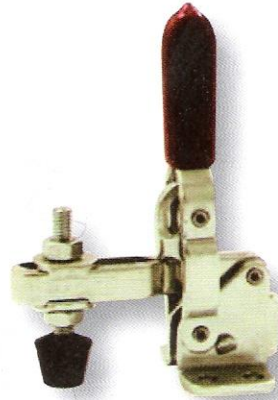

KAKUTA EUROPE GmbH - Luisenstraße 9, 90762 Fürth - Germany

0800 - KAKUTA EU

Tel.: +49 (0) 911 - 766-2842

Fax.: +49 (0) 911 - 766-2843

E-mail.: info@kakuta.eu

Web: www.kakuta.eu

KAKUTA EUROPE GmbH - Luisenstraße 9, 90762 Fürth - Germany

Fax.: +49 (0) 911 - 766-2843

Unternehmen	Abteilung
Anrede	Titel
Vorname	Nachname
Anschrift	
Postleitzahl, Ort	
E-Mail	Anmerkungen:
Telefon	
Telefax	

Ja, ich möchte mehr über Kakuta erfahren, bitte...

- ...senden Sie mir Infomaterial zu!
- ...nehmen Sie Kontakt zu mir auf!
- ...beraten Sie mich persönlich!

Ihr Stempel / Ihr Zeichen



KAKUTA TOGGLE CLAMPS

Introduction

Kakuta Kikai Seisaku Company was established in 1938 to apply for patent on quick clamping element with toggle action in Japan. The manual toggle clamps have been developed initially to meet the leading Japanese automobile manufacturers' requirement. Kakuta toggle clamps have been expanded rapidly along with the fast growing Japanese automobile industries namely Toyota, Nissan, Honda, Fujijyuko(Subaru), Matsuda, Isuzu, Mitsubishi and Hino.

With our great experience, Kakuta clamps have been further technically designed to meet a wider range of applications for electronic, iron and steel, photochemistry, aircraft, mining, ship, railroad and tracks, food, oil, agriculture and woodworking. Kakuta Kogyo Co., Ltd. have been renamed since 1962.

Selection the Proper KAKUTA Clamp

To obtain the proper clamp, the following points should be carefully taken into consideration. However, our representatives or Kakuta distributor personnel are willing to be of your assistance.

- Main Purpose
- Holding Capacity Requirement
- Shape and Dimension of the object to be held
- Operator Ability (Strength and Skill)
- Frequency of Operation
- Necessary function (press and pressure, creating pressure)

Create Clamp to Your Specification

Besides our large selection of standard size clamps, we are willing to modify and/or create such special clamp for your specific purpose. Please do not hesitate to consult our representatives or Kakuta distributor personnel.

Holding Capacity

The Holding Capacity of each clamp as specified therein this catalogue refers to the maximum which may be applied to work holding bar or jaws in the closed position.

Measurements

The units of length are in metric. For imperial measurement, please refer to our website: kakutaus.com

Catalogue Information

PREFIX	ACTION STYLE	SUFFIX	DESCRIPTION
HH	Hold Down Horizontal Handle	U	U-Bar
HV	Hold Down Vertical Handle	B/SB/BN	Straight Base
UF/SF	Hold Down Special Clamp	T	T-Handle
PA/FA	Pull/Fasten Action	L	Long Arm/Large
SL/FM	Straight Line/Flush Mounting	LE	Left Base
SA	Squeeze Action	R	Right Base
V	Vari Clamp-Heavy Duty	SL	Straight Line
AC	Air Clamp	S	Solid Bar/Small
		2S	Stainless Steel
		X	Heavy Duty (Extra)
		V	Vertical Handle
		RR	Right Rotation
		LR	Left Rotation



NUMERICAL INDEX

HOLD DOWN ACTION HORIZONTAL HANDLE	
HH 150	2
HH 150-2S	2
HH 151-B	2
HH 151-B2S	2
HH 154-LE	2
HH 155-R	2
HH 250	3
HH 250-2S	3
HH 251-B	3
HH 251-B2S	3
HH 254-LE	3
HH 255-R	3
HH 300	4
HH 300-2S	4
HH 301-B	4
HH 301-B2S	4
HH 350	5
HH 350-2S	5
HH 351-B	5
HH 351-B2S	5
HH 350-S	5
HH 351-SB	5
HH 400	4
HH 400-2S	4
HH 401-B	4
HH 401-B2S	4
HH 450	6
HH 450-2S	6
HH 451-B	6
HH 451-B2S	6
HH 500	4
HH 500-2S	4
HH 501-B	4
HH 501-B2S	4
HH 550	6
HH 551-B	6
HH 551-BN	6
HH 600	4
HH 601-B	4
HOLD DOWN ACTION VERTICAL HANDLE	
HV 150	7
HV 150-2S	7
HV 151-B	7
HV 151-B2S	7
HV 151-BT	7
HV 152-T	7
HV 153-XL	7
HV 200	7
HV 200-2S	7
HV 250	8
HV 250-2S	8
HV 251-B	8
HV 251-B2S	8
HV 251-BT	8
HV 252-T	8
HV 250-U	8

HV 250-U2S	8
HV 251-UB	8
HV 251-UBT	8
HV 252-UT	8
HV 253-UL	8
HV 253-UL2S	8
HV 300	7
HV 300-2S	7
HV 350	9
HV 351-B	9
HV 351-BT	9
HV 351-BL	9
HV 351-BTL	9
HV 352-T	9
HV 352-TL	9
HV 353-L	9
HV 400	7
HV 400-2S	7
HV 450	10
HV 450-2S	10
HV 451-B	10
HV 451-B2S	10
HV 451-BT	10
HV 451-BL	10
HV 451-BTL	10
HV 452-T	10
HV 452-TL	10
HV 453-L	10
HV 453-XL	10
HV 550	11
HV 551-B	11
HV 551-BT	11
HV 552-T	11
HV 650	12
HV 651-B	12
HV 651-BT	12
HV 652-T	12
HV 750	13
HV 751-B	13
HV 850	13
HV 851-B	13
HV 950	13
HV 951-B	13
HV 1050	13
HV 1051-B	13
SPECIAL HOLD DOWN ACTION CLAMPS	
SF 350	14
UF 450	14
No. 82	14
No. 82-S	14
No. 38B(S)	15
No. 38S(S)	15
No. 38B(L)	15
No. 38S(L)	15
No. 42A	16
No. 42A-2S	16
No. 42K	16
No. 42K-2S	16

No. 42P	16
No. 42S	16
PULL/FASTEN ACTION	
PA 150	17
PA 170	17
PA 250	17
PA 250-2S	17
PA 251-B	17
PA 251-B2S	17
PA 270	17
PA 350	17
FA 100	18
FA 100-2S	18
FA 102	19
FA 102-2S	19
FA 130	19
FA 130-2S	19
FA 140	20
FA 140-2S	20
FA 200	18
FA 200-2S	18
FA 202	19
FA 202-2S	19
FA 230	19
FA 230-2S	19
FA 240	20
FA 240-2S	20
FA 300	18
FA 300-2S	18
FA 302	19
FA 330	19
FA 340	20
FA 600	20
FA 601-B	21
FA 700	21
STRAIGHT LINE ACTION	
SL 07	22
SL 10	22
SL 10-2S	22
SL 15-2	22
SL 15-22S	22
SL 70	23
SL 70-2S	23
SL 100	23
SL 105-2	24
SL 105-22S	24
SL 110	24
SL 111-B	24
SL 150	25
SL 160	25
SL 200	23
SL 210	26
SL 240	26
SL 241-B	26
SL 250	27
SL 251-B	27
SL 300	23
SL 310	27
SL 350	27

SL 450	27
No. 02	28
No. 51	28
FM 50	29
FM 50-2S	29
FM 150	29
FM 150-2S	29
FM 150-1	29
FM 250	29
SQUEEZE ACTION	
SA 2	30
SA 150	30
SA 155-2	30
SA 250	31
SA 255-2	31
SA 350	31
SA 450	32
SA 455-2	32
SA 550	32
HOLD DOWN HEAVY DUTY (Profile)	
V. 1	34
V. 1-SB	35
V. 2	34
V. 2-SB	35
V. 3	34
V. 1X	36
V. 1X-B	37
V. 2X	36
V. 2X-B	37
V. 3X	36
V. 3X-B	37
AIR CLAMP	
AC 250	38
AC 350	38
AC 353-L	38
AC 450	39
AC 453-L	39
AC 550	39
AC 650	40
AC 100-SL	41
AC 350-SL	41
Accessories	42
Cross Reference	43

Horizontal Handle



HOLD DOWN ACTION

Series HH 150

This is a smallest horizontal handle hold-down clamp. Ideal for light weight materials and light work production or assembly operations. Solid bar with fixed spindle position furnished with M4 nylon hex head spindle and red vinyl handle grip but stainless steel models supplied with stainless steel hex head spindles.



Also Available in
Stainless Steel
HH 150-2S
HH 151-B2S

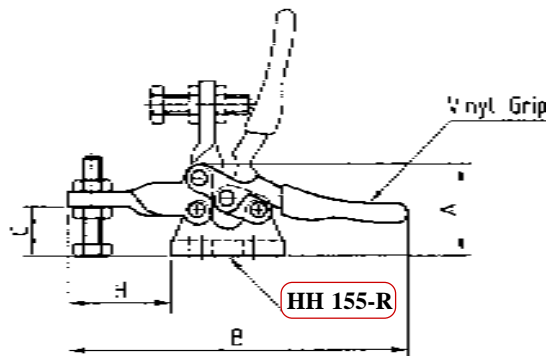
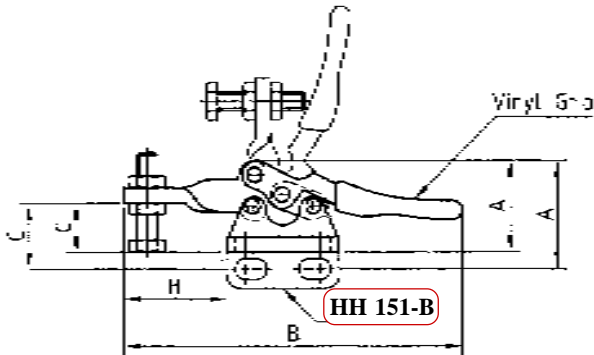
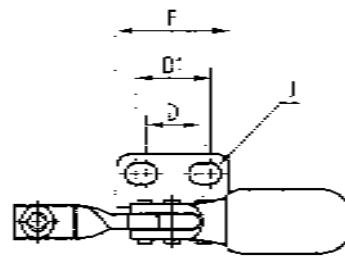
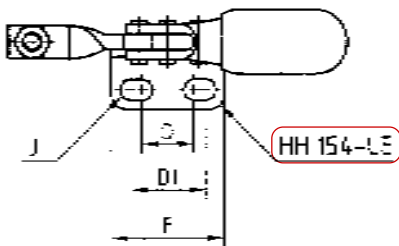
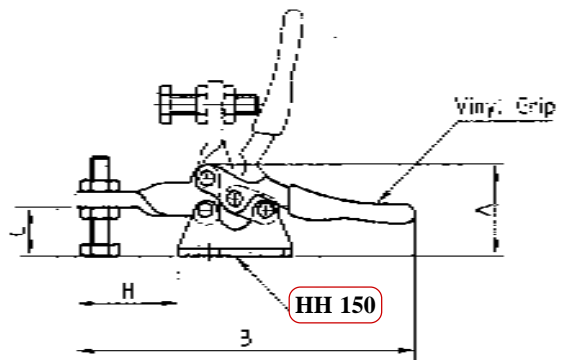
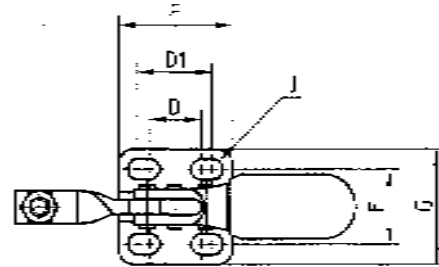

Model	A	B	C	D	D1	E	F	G	H	J/SLOT	Holding Capacity	Shipping Weight	Handle Moves	Bar moves
HH 150	19	72	10.3	11.1	15.9	15.9	24.3	24.3	22	4.4 x 6.7	27 Kg	27 g	70°	90°
HH 151-B	23	72	14	11.1	15.9	-	24.3	-	22	4.4 x 6.7	27 Kg	27 g	70°	90°
HH 155-R	19	72	10.3	11.1	15.9	-	24.3	-	22	4.4 x 6.7	27 Kg	27 g	70°	90°
HH 154-LE	19	72	10.3	11.1	15.9	-	24.3	-	22	4.4 x 6.7	27 Kg	27 g	70°	90°

Horizontal Handle



HOLD DOWN ACTION

Series HH 250

The smallest horizontal handle hold-down U-bar clamp supplied with M4 nylon hex head spindle adjustable and 2 flanged washers. Red vinyl handle grip provided for handle comfort. Stainless steel models are supplied with stainless steel hex head spindle assemblies.



Also Available in
Stainless Steel
HH 250-2S
HH 251-B2S

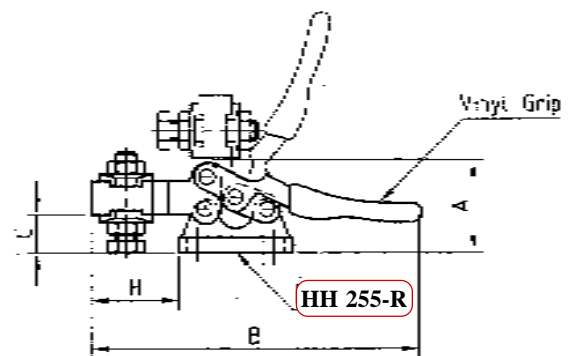
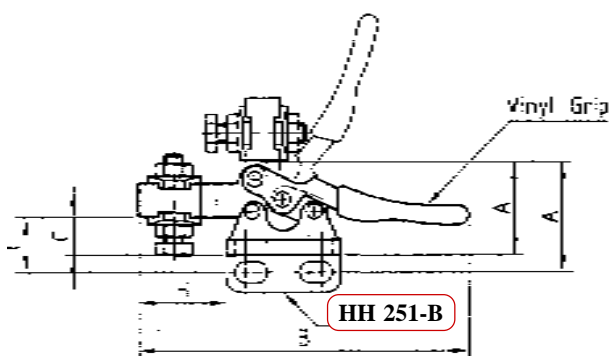
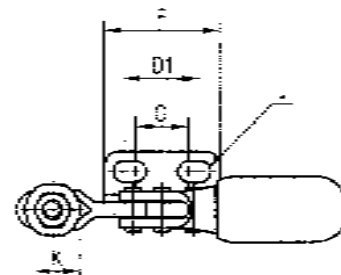
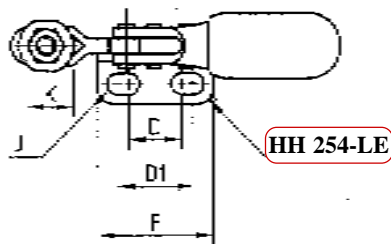
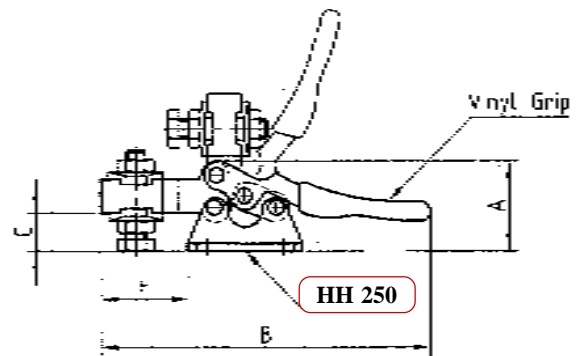
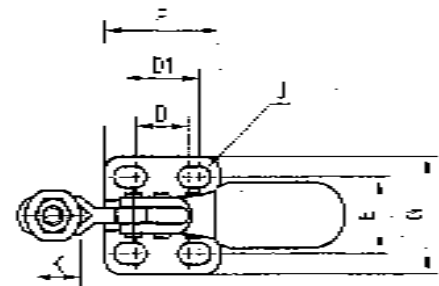

Model	A	B	C	D	D1	E	F	G	H	J/SLOT	K	Holding Capacity	Shipping Weight	Handle Moves	Bar moves
HH 250	19	69	7.9	11.1	15.9	15.9	24.3	24.3	19	4.4 x 6.7	9.6	27 Kg	27 g	70°	90°
HH 251-B	23	69	12.1	11.1	15.9	-	24.3	-	19	4.4 x 6.7	9.6	27 Kg	27 g	70°	90°
HH 254-LE	19	69	7.9	11.1	15.9	-	24.3	-	19	4.4 x 6.7	9.6	27 Kg	27 g	70°	90°
HH 255-R	19	69	7.9	11.1	15.9	-	24.3	-	19	4.4 x 6.7	9.6	27 Kg	27 g	70°	90°

Horizontal Handle



HOLD DOWN ACTION

HH 300, HH 400, HH 500, HH 600

These series offer in four different standard sizes. They are designed to provide more hand clearance when clamps are in full open position. Each model is equipped with red vinyl handle grip. Stainless Steel models are supplied with stainless steel hex head spindle assemblies.



Also Available in Stainless Steel

HH 300-2S HH 400-2S
HH 301-B2S HH 401-B2S
HH 500-2S
HH 501-B2S

Straight Base

HH 301-B
HH 401-B
HH 501-B
HH 601-B

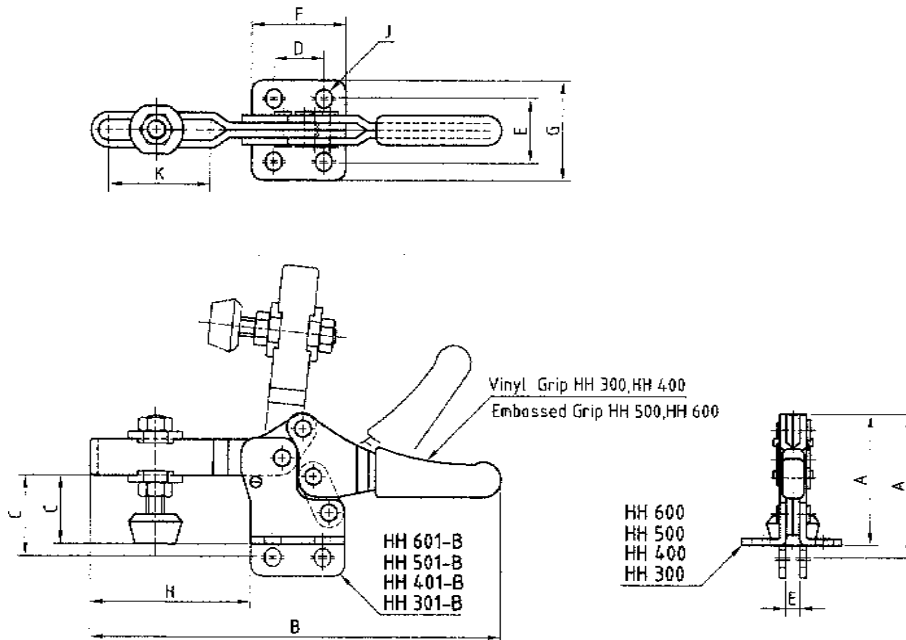

Model	A	B	C	D	E	F	G	H	J/SLOT	K	Holding Capacity	Shipping Weight	Handle Moves	Bar moves
HH 300	35.5	111	18.5	13.5	17.6	25.4	27	43.4	4.4 x 5.2	27.5	68 Kg	80 g	55°	96°
HH 301-B	38.5	111	21.2	13.5	4	25.4	-	43.4	4.4 x 5.2	27.5	68 Kg	80 g	55°	96°
HH 400	49.4	160.5	24	26	28	37.4	38.6	61.8	5.5 x 8.5	40	90 Kg	205 g	55°	96°
HH 401-B	55.4	160.5	30	26	5.2	37.4	-	61.8	5.5 x 8.5	40	90 Kg	205 g	55°	96°
HH 500	61.8	195	34	26	31	40	43.6	67.3	6.6 x 9.1	33	227 Kg	322 g	55°	96°
HH 501-B	66.8	195	39	26	6.4	40	-	67.3	6.6 x 9.1	33	227 Kg	322 g	55°	96°
HH 600	80.8	270	44.5	41	43	57	58	103	8 x 10	70	340 Kg	725 g	55°	96°
HH 601-B	89.5	270	53.5	41	8	57	-	103	8 x 10	70	340 Kg	725 g	55°	96°

Horizontal Handle



HOLD DOWN ACTION

Series HH 350 HH 350-S

Two different bar styles of medium duty clamp make the spindle position adjustable and fixed(HH 350-S). The Solid Bar style, HH 350-S is equipped with Bolt Retainer. Red vinyl handle grips are provided for handle comfort. Stainless steel models are provided with stainless steel hex head spindle assemblies.

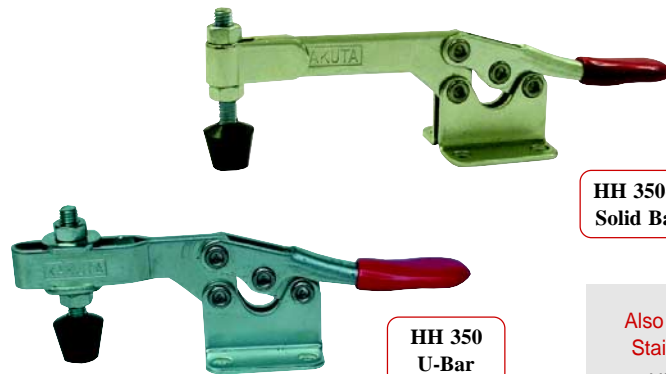

**HH 350-S
Solid Bar**

**HH 350
U-Bar**

Also Available in
Stainless Steel
HH 350-2S
HH 351-B2S

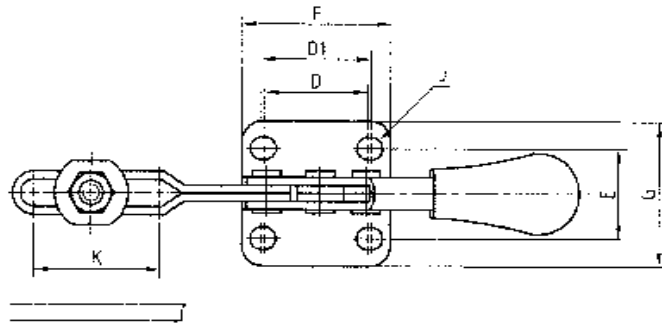

Straight Base
HH 351-B
HH 351-SB

HH 351-SB
HH 350-S

HH 351-B
HH 350

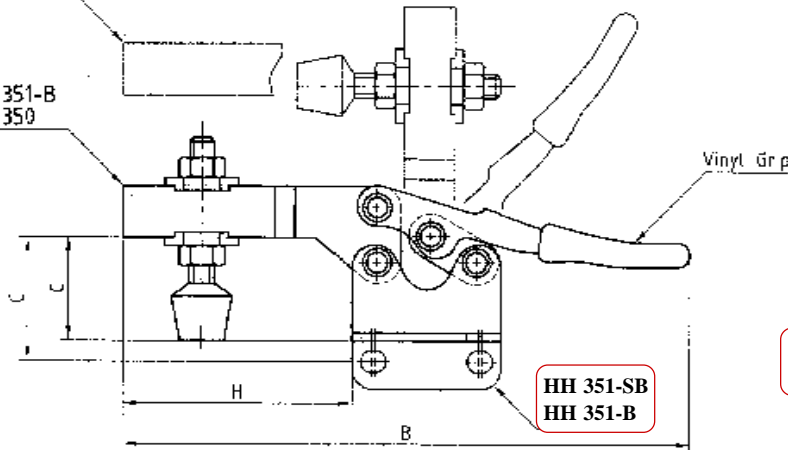

**HH 350-S
HH 350**

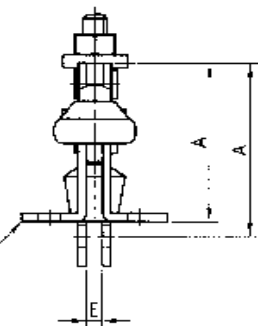

Model	A	B	C	D	D1	E	F	G	H	J/SLOT	K	Holding Capacity	Shipping Weight	Handle Moves	Bar moves
HH 350	38.1	139.6	25.4	25.4	27	22.2	36.6	35.7	56.5	5.2 x 6.	31	90 Kg	125 g	60°	90°
HH 351-B	43.3	139.6	30.6	25.4	27	4	36.6	-	56.5	5.2 x 6	31	90 Kg	125 g	60°	90°
HH 350-S	38.1	139.6	25.4	25.4	27	22.2	36.6	35.7	56.5	5.2 x 6	-	90 Kg	125 g	60°	90°
HH 351-SB	43.3	139.6	30.6	25.4	27	4	36.6	-	56.5	5.2 x 6	-	90 Kg	125 g	60°	90°

Horizontal Handle



HOLD DOWN ACTION

HH 450

Provides a larger in dimension and holding capacity. Equipped with a red vinyl handle grip.



Also Available in
Stainless Steel
HH 450-2S
HH 451-B2S

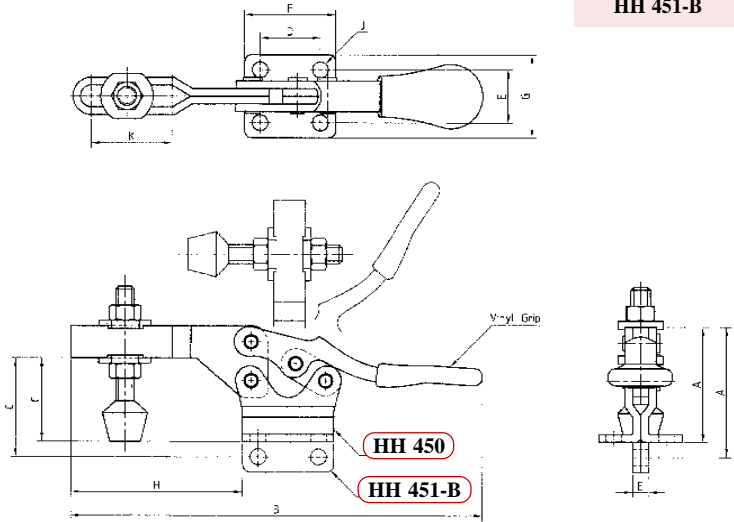

Straight Base
HH 451-B

Model	A	B	C	D	E	F	G	H	J	K	Holding Capacity	Shipping Weight	Handle Moves	Bar moves
HH 450	48.4	173.4	34.9	25.4	22.2	38.5	34.8	72.4	6.7	34	240 Kg	274 g	60°	90°
HH 451-B	54.8	173.4	41.3	25.4	6.4	38.5	-	72.4	6.7	34	240 Kg	274 g	60°	90°

Series HH 550

One of the two largest horizontal U-Bar clamps is equipped with red vinyl handle grip. There are two different types of Straight Base model.



Straight Base
HH 551-B
HH 551-BN

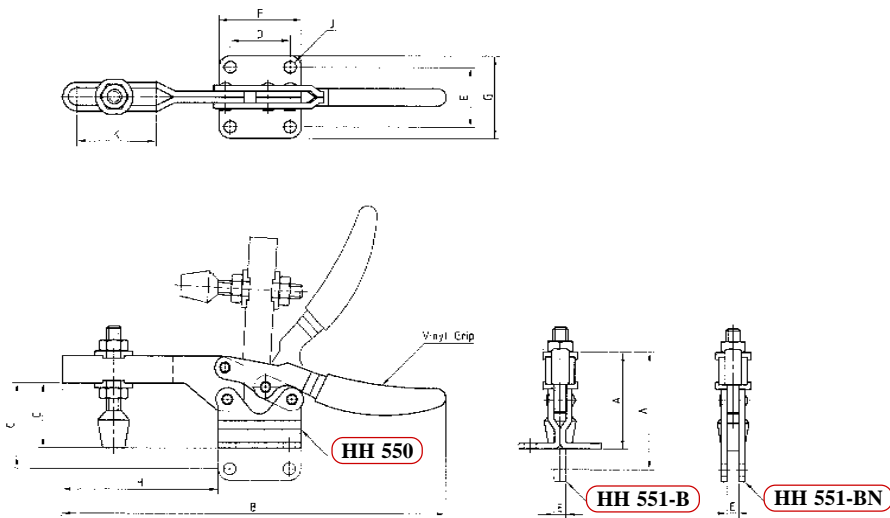

Model	A	B	C	D	E	F	G	H	J	K	Holding Capacity	Shipping Weight	Handle Moves	Bar moves
HH 550	63.5	265	44.5	41.2	41.2	57.2	57.2	108	8.3	54.5	340 Kg	686 g	65°	93°
HH 551-B	77.8	265	58.8	41.2	8	57.2	-	108	8.3	54.5	340 Kg	686 g	65°	93°
HH 551-BN	78.4	265	59.3	41.2	8	57.2	-	108	8.3	54.5	340 Kg	686 g	65°	93°

Vertical Handle



HOLD DOWN ACTION

Series HV 150

The smallest vertical handle clamp is applicable for light duty. Supplied with vinyl-coated hex-head spindle assemblies and two flanged washers. Red vinyl handle grips are provided except T-Bar model. Stainless steel models are supplied with stainless steel hex head spindle assemblies.



Also Available in
Stainless Steel
HV 150-2S
HV 151-B2S

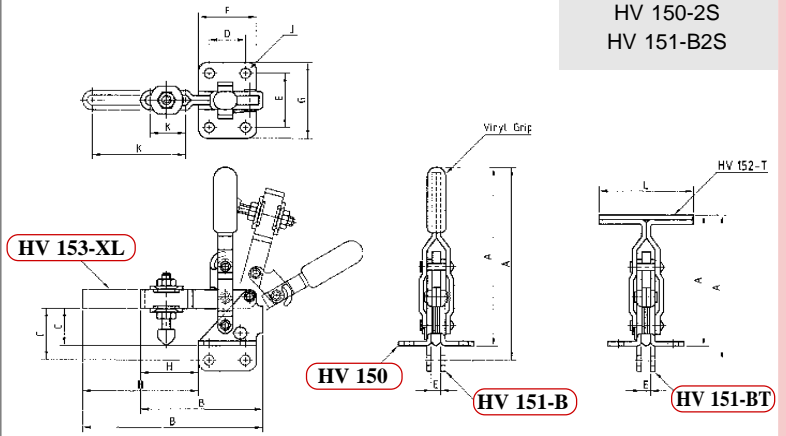

Model	A	B	C	D	E	F	G	H	J	K	L	Holding Capacity	Shipping Weight	Handle Moves	Bar moves
HV 150	78.5	53.9	15.9	15.9	23.8	25.5	33.4	25.5	4.4	15.5	-	45 Kg	66 g	60°	105°
HV 151-B	84.2	53.9	22.6	15.9	4	25.5	-	25.5	4.4	15.5	-	45 Kg	66 g	60°	105°
HV 151-BT	64.1	53.9	22.6	15.9	4	25.5	-	25.5	4.4	15.5	46	45 Kg	70 g	60°	105°
HV 152-T	57.7	53.9	15.9	15.9	23.8	25.5	33.4	25.5	4.4	15.5	46	45 Kg	70 g	60°	105°
HV 153-XL	78.5	79.4	15.9	15.9	23.8	25.5	33.4	51	4.4	42	-	27 Kg	80 g	60°	105°

HV 200 HV 300 HV 400

The unique handle is special designed that can also be operated from behind. Each model is provided with red vinyl handle grip and furnished with spindle assemblies and two flanged washers. Stainless steel models are supplied with stainless steel hex head spindle assemblies.



Also Available in
Stainless Steel
HV 200-2S
HV 300-2S
HV 400-2S

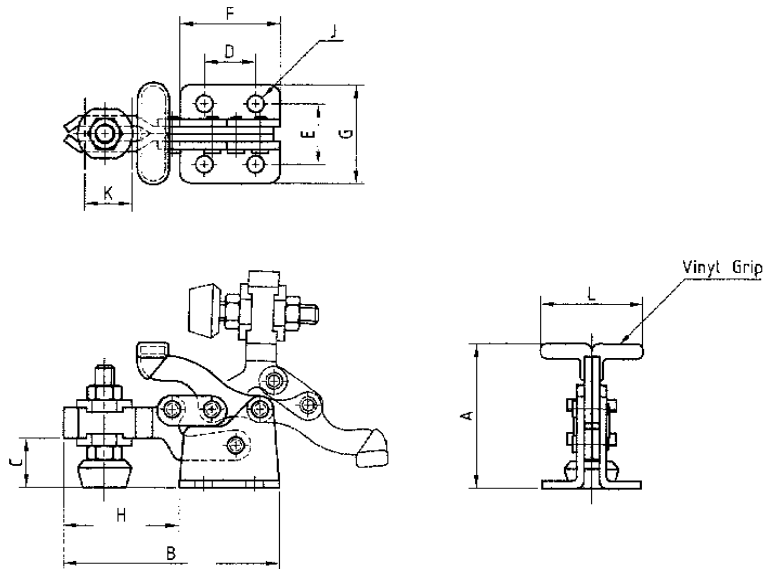

Model	A	B	C	D	E	F	G	H	J	K	L	Holding Capacity	Shipping Weight	Handle Moves	Bar moves
HV 200	38.1	57.1	13	13.5	16	26.5	26	30.6	4.5	12.7	27	68 kg	58 g	175°	92°
HV 300	62.5	93.5	22	23	29	44	46	49.5	6.5	19	50	150 Kg	220 g	175°	92°
HV 400	93.5	130.5	33	35	38	64	63	66.5	8.5	27	70	340 Kg	630 g	175°	92°

Vertical Handle



HOLD DOWN ACTION

Series HV 250

The spindle position is fixed for solid bar series. Straight Base and T-Handle models are also available. Red vinyl handle grips are provided except T-Bar model. Stainless steel models are supplied with stainless steel hex head spindle assemblies.

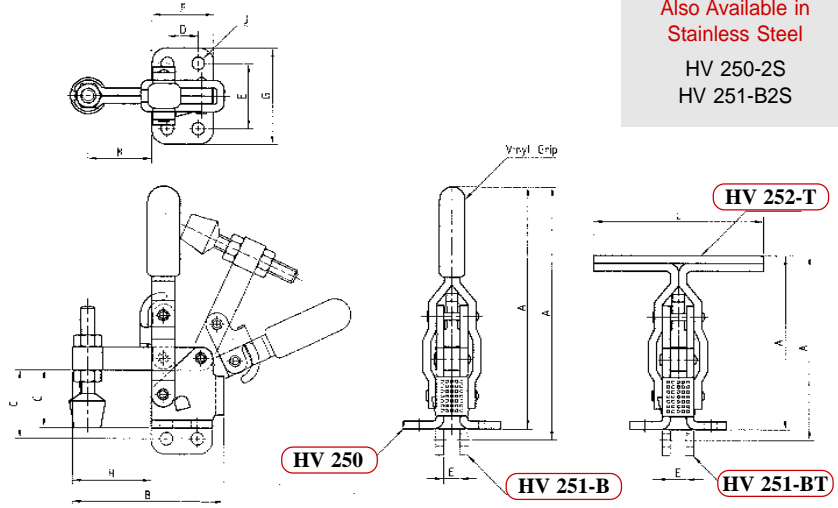

Also Available in Stainless Steel

HV 250-2S
HV 251-B2S

Model	A	B	C	D	E	F	G	H	J	K	L	Holding Capacity	Shipping Weight	Handle Moves	Bar moves
HV 250	100	62.5	23.8	12.7	27	25.5	39.8	32.5	5.2	26.3	-	90 Kg	167 g	65°	115°
HV 251-B	104.5	62.5	28.5	12.7	6.4	25.5	-	32.5	5.2	26.3	-	90 Kg	167 g	65°	115°
HV 251-BT	76.2	62.5	28.5	12.7	6.4	25.5	-	32.5	5.2	26.3	70	90 Kg	170 g	65°	115°
HV 252-T	71.8	62.5	23.8	12.7	27	25.5	39.8	32.5	5.2	26.3	70	90 Kg	170 g	65°	115°

Series HV 250-U

Similar dimension to HV 250 but spindle position is adjustable along the U-Bar. Each model is equipped with red vinyl handle grip except T-Handle model. Stainless steel models are provided with stainless steel hex head spindle assemblies.

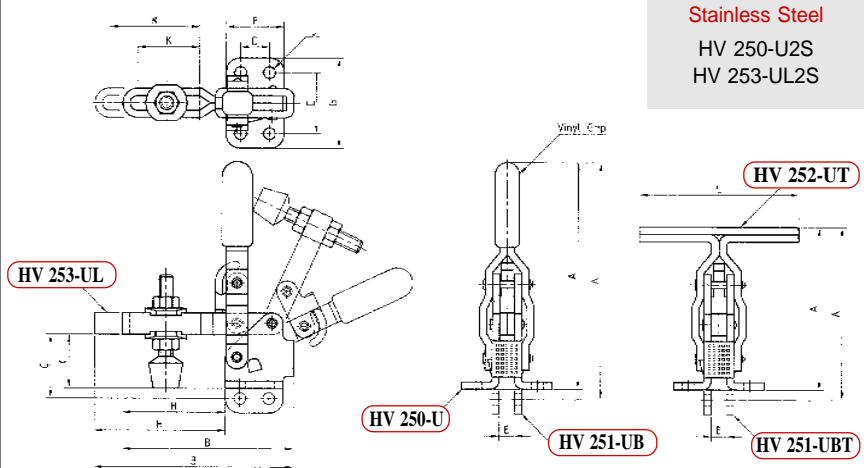

Also Available in Stainless Steel

HV 250-U2S
HV 253-UL2S

Model	A	B	C	D	E	F	G	H	J	K	L	Holding Capacity	Shipping Weight	Handle Moves	Bar moves
HV 250-U	100	75.6	23.8	12.7	27	25.5	39.8	45.6	5.2	27.5	-	90 Kg	167 g	65°	115°
HV 251-UB	104.5	75.6	28.5	12.7	6.4	25.5	-	45.6	5.2	27.5	-	90 Kg	167 g	65°	115
HV 251-UBT	76.2	75.6	28.5	12.7	6.4	25.5	-	45.6	5.2	27.5	70	90 Kg	170 g	65°	115°
HV 252-UT	71.8	75.6	23.8	12.7	27	25.5	39.8	45.6	5.2	27.5	70	90 Kg	170 g	65°	115°
HV 253-UL	100	87.8	23.8	12.7	27	25.5	39.8	57.8	5.2	39.7	-	50 Kg	170 g	65°	115°

Vertical Handle



HOLD DOWN ACTION

Series HV 350

Two standard models are identical. HV 350, the solid bar model is furnished with bolt retainer. Embossed red handle grip provided.



HV 350
Solid Bar

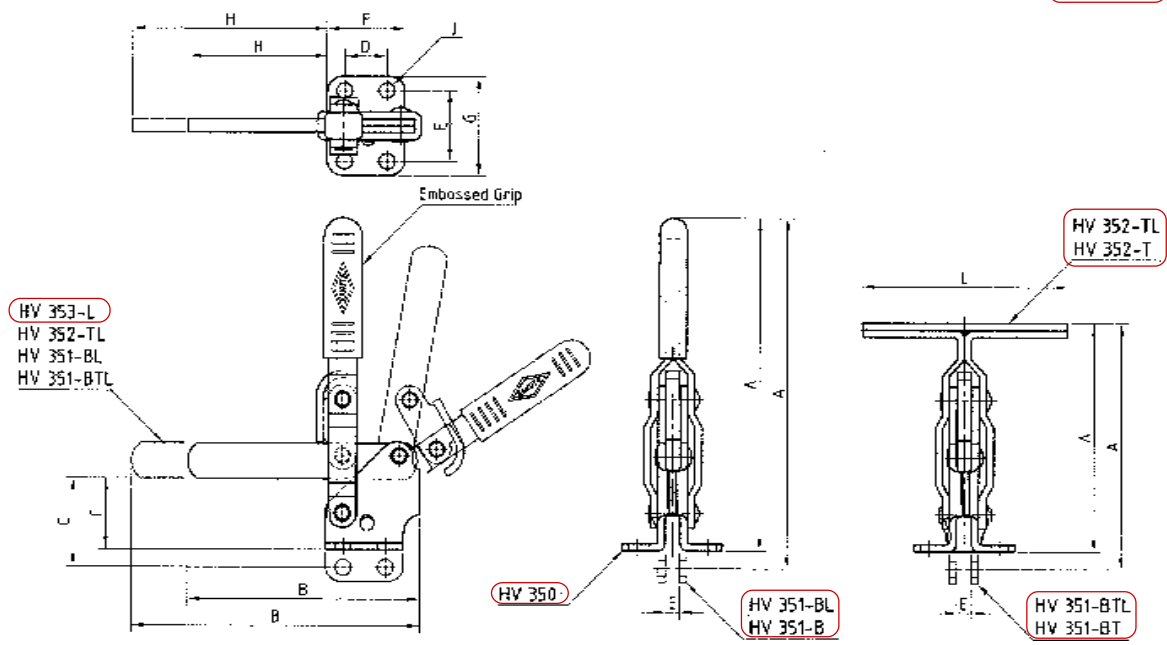

Model	A	B	C	D	E	F	G	H	J	L	Holding Capacity	Shipping Weight	Handle Moves	Bar moves
HV 350	149	104.5	31.8	19	31.8	35	44.6	62	7.1	-	225 Kg	350 g	60°	100°
HV 351-B	157.2	104.5	39.7	19	6.4	35	-	62	7.1	-	225 Kg	350 g	60°	100°
HV 351-BT	109.6	104.5	39.7	19	6.4	35	-	62	7.1	92	225 Kg	370 g	60°	100°
HV 351-BL	157.2	129.8	39.7	19	6.4	35	-	87.3	7.1	-	110 Kg	380 g	60°	100°
HV 351-BTL	109.6	129.8	39.7	19	6.4	35	-	87.3	7.1	92	110 Kg	390 g	60°	100°
HV 352-T	101.7	104.5	31.8	19	31.8	35	44.6	62	7.1	92	225 Kg	370 g	60°	100°
HV 352-TL	101.7	129.8	31.8	19	31.8	35	44.6	87.3	7.1	92	110 Kg	390 g	60°	100°
HV 353-L	149	129.8	31.8	19	31.8	35	44.6	87.3	7.1	-	110 Kg	380 g	60°	100°

Vertical Handle



HOLD DOWN ACTION

Series HV 450

Similar to HV350 except U-bar. Provided embossed grip and furnished with spindle assemblies/flanged washers. Stainless steel supplied with stainless steel hex head spindle assemblies.

Also Available in stainless steel
HV450-2S
HV451-B2S

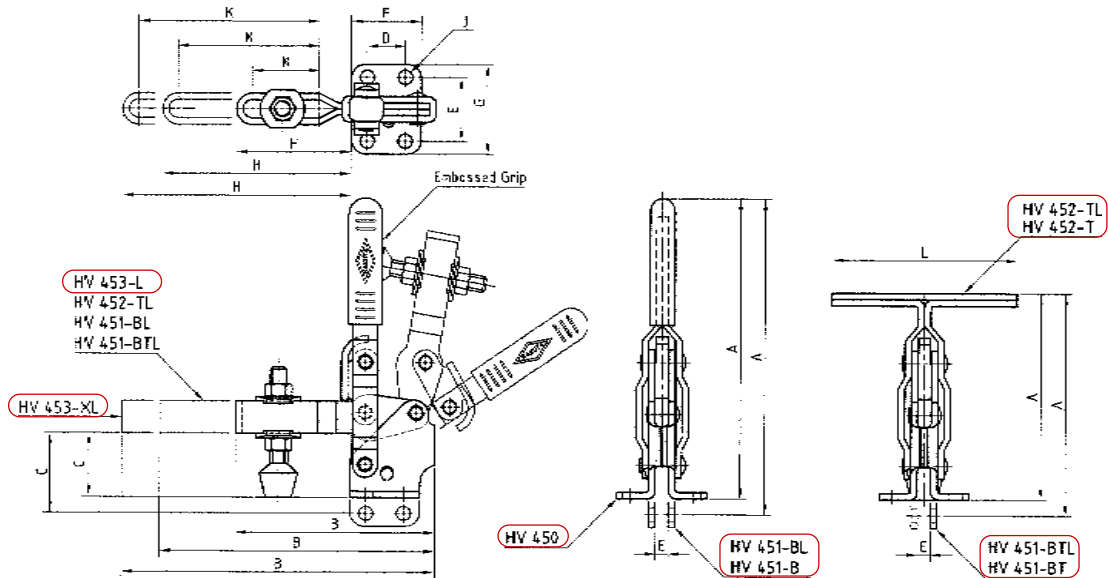

Model	A	B	C	D	E	F	G	H	J	K	L	Holding Capacity	Shipping Weight	Handle Moves	Bar moves
HV 450	149	99.7	31.8	19	31.8	35	44.6	57.2	7.1	33.5	-	225 Kg	350 g	60°	100°
HV 451-B	157.2	99.7	39.7	19	6.4	35	-	57.2	7.1	33.5	-	225 Kg	350 g	60°	100°
HV 451-BT	109.6	99.7	39.7	19	6.4	35	-	57.2	7.1	33.5	92	225 Kg	370 g	60°	100°
HV 451-BL	157.2	137.7	39.7	19	6.4	35	-	95.2	7.1	71	-	100 Kg	380 g	60°	100°
HV 451-BTL	109.6	137.7	39.7	19	6.4	35	-	95.2	7.1	71	92	100 Kg	400 g	60°	100°
HV 452-T	101.7	99.7	31.8	19	31.8	35	44.6	57.2	7.1	33.5	92	225 Kg	370 g	60°	100°
HV 452-TL	101.7	137.7	31.8	19	31.8	35	44.6	95.2	7.1	71	92	100 Kg	400 g	60°	100°
HV 452-L	149	137.7	31.8	19	31.8	35	44.6	95.2	7.1	71	-	100 Kg	380 g	60°	100°
HV 453-XL	149	156.5	31.8	19	31.8	35	44.6	114	7.1	90	-	80 Kg	440 g	60°	100°

Vertical Handle



HOLD DOWN ACTION

Series HV 550

Two standard models, HV 550 and HV 650 are identical. Bolt retainer furnished with solid bar model, HV 550. Embossed red handle grip provided except T-bar model.

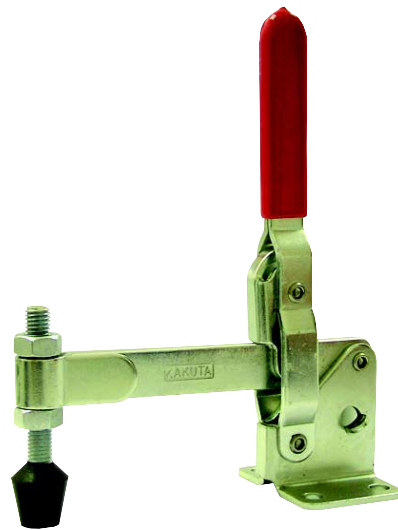

HV 550
Solid Bar

HV 551-B
Straight Base

HV 551-BT
Straight Base/T-Handle

HV 552-T
T-Handle

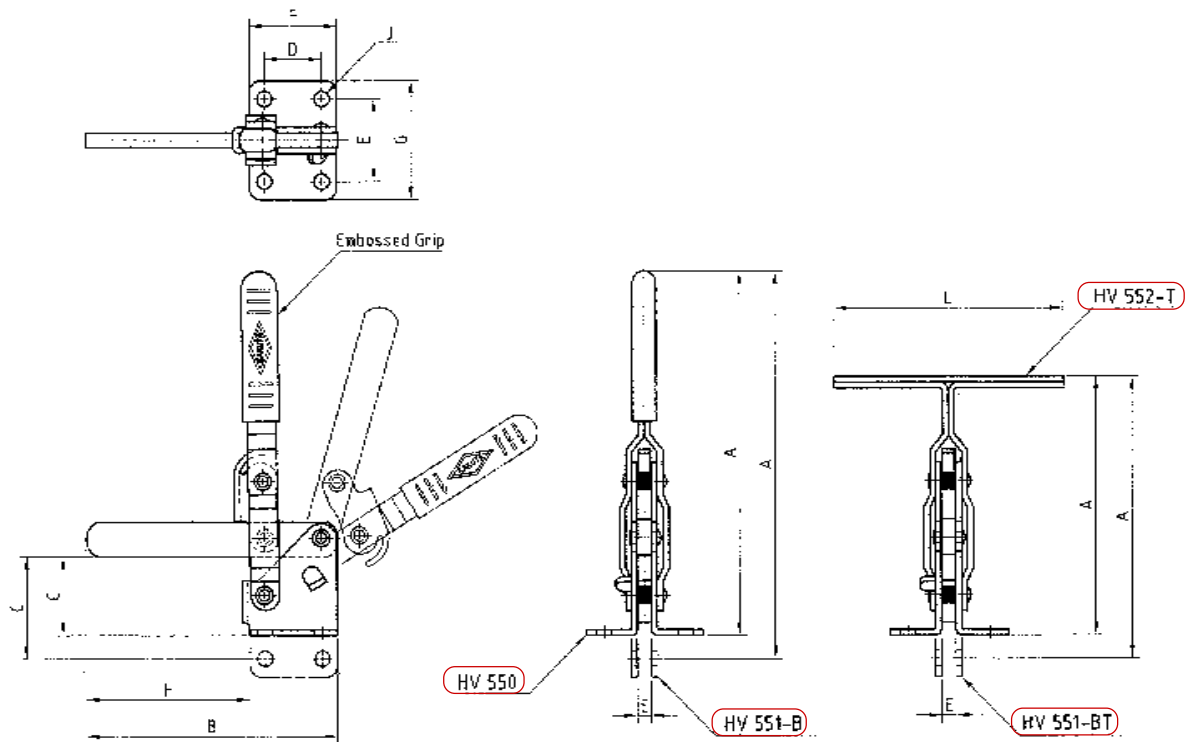

Model	A	B	C	D	E	F	G	H	J	L	Holding Capacity	Shipping Weight	Handle Moves	Bar moves
HV 550	199	139.4	42.9	31.8	45.2	48.4	65.2	91	8.4	-	340 Kg	660 g	58°	106°
HV 551-B	212	139.4	55.6	31.8	8	48.4	-	91	8.4	-	340 Kg	660 g	58°	106°
HV 551-BT	154	139.4	55.6	31.8	8	48.4	-	91	8.4	127	340 Kg	660 g	58°	106°
HV 552-T	141	139.4	42.9	31.8	45.2	48.4	65.2	91	8.4	127	340 Kg	660 g	58°	106°

Vertical Handle



HOLD DOWN ACTION

Series HV 650

Similar to HV550 except U-bar. HV 650, the U-bar model equipped with 2 flanged washers and spindle assemblies. Embossed red handle grip also provided except T-bar model.

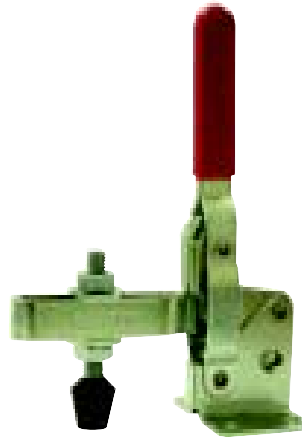

HV 650
U-bar

HV 651-B
Straight Base

HV 651-BT
Straight Base/T-Handle

HV 652-T
T-Handle

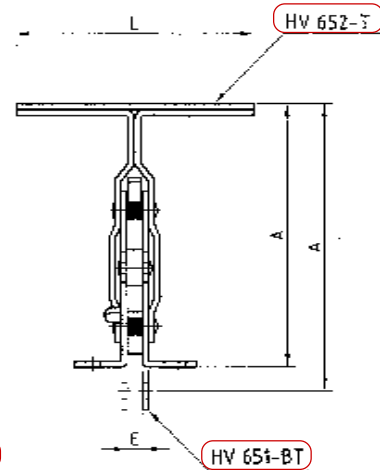
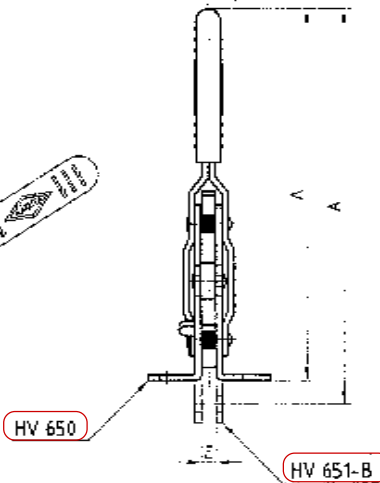
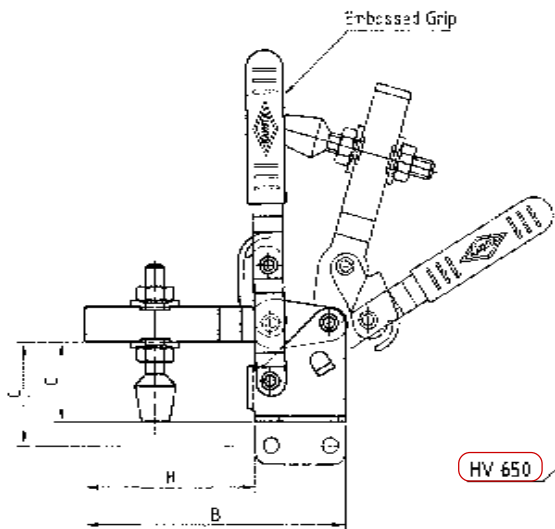
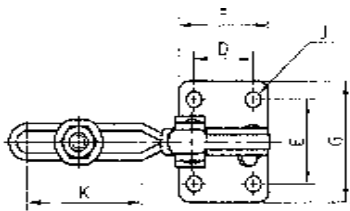

Model	A	B	C	D	E	F	G	H	J	K	L	Holding Capacity	Shipping Weight	Handle Moves	Bar moves
HV 650	199	139.4	42.9	31.8	45.2	48.4	65.2	91	8.4	61	-	340 Kg	660 g	58°	106°
HV 651-B	212	139.4	55.6	31.8	8	48.4	-	91	8.4	61	-	340 Kg	660 g	58°	106°
HV 651-BT	154	139.4	55.6	31.8	8	48.4	-	91	8.4	61	127	340 Kg	660 g	58°	106°
HV 652-T	141	139.4	42.9	31.8	45.2	48.4	65.2	91	8.4	61	127	340 Kg	660 g	58°	106°

Vertical Handle



HOLD DOWN ACTION

HV 750
HV 850
HV 950
HV 1050

HV 750
 HV 950
 Solid Bar

HV 850
 HV 1050
 U-Bar



Heavy duty models of the Vertical Handle are available in U-Bar and solid bar models. Also, they are available in Straight Base models. Bolt retainer is furnished with solid bar but two flanged washers furnished with U-Bar model. Red vinyl handle grips are provided. Spindle must be ordered separately.

Straight Base
 HV 751-B
 HV 851-B
 HV 951-B
 HV 1051-B

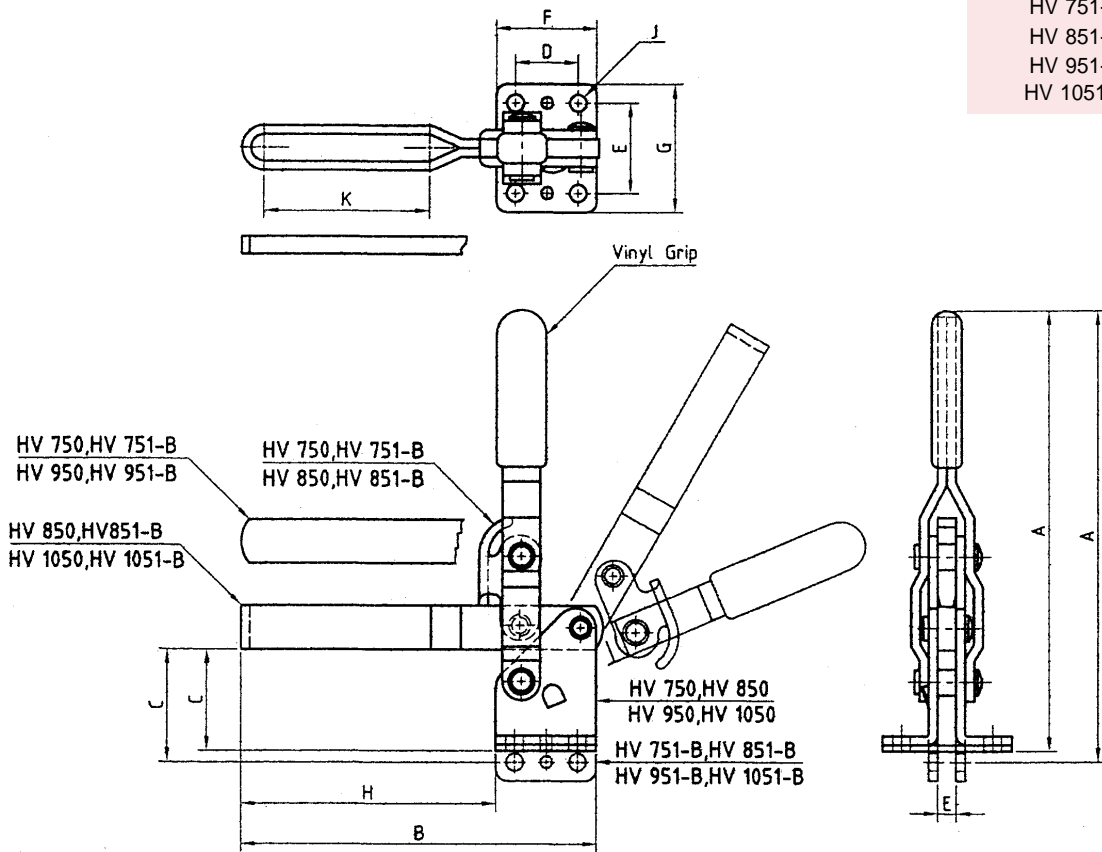

Model	A	B	C	D	E	F	G	H	J	K	Holding Capacity	Shipping Weight	Handle Moves	Bar moves
HV 750	221.3	177.8	50.8	31.8	45.3	50.8	64.3	127	8.7	-	454 Kg	1020 g	67°	120°
HV 751-B	226.5	177.8	56.6	31.8	9	50.8	-	127	8.7	-	454 Kg	1020 g	67°	120°
HV 850	221.3	177.8	50.8	31.8	45.3	50.8	64.3	127	8.7	82	454 Kg	1020 g	67°	120°
HV 851-B	226.5	177.8	56.5	31.8	9	50.8	-	127	8.7	82	454 Kg	1020 g	67°	120°
HV 950	308	225.2	82.5	50.8	69.8	76.2	95	149	12.7	-	545 Kg	2060 g	70°	140°
HV 951-B	328.3	225.2	102.5	50.8	9	76.2	-	149	12.7	-	545 Kg	2060 g	70°	140°
HV 1050	308	225.2	82.5	50.8	69.8	76.2	95	149	12.7	95	545 Kg	2060 g	70°	140°
HV 1051-B	328.3	225.2	102.5	50.8	9	76.2	-	149	12.7	95	545 Kg	2060 g	70°	140°

Special Hold Down Clamp



HOLD DOWN ACTION

SF 350 UF 450

Each model has two mounting areas, horizontal and vertical surfaces. The embossed handle grips are included for firm handle comfort. SF 350, the solid bar model is furnished with bolt retainer and spindle assembly. The U-Bar model, UF 450 is furnished with flanged washers and spindle assembly.

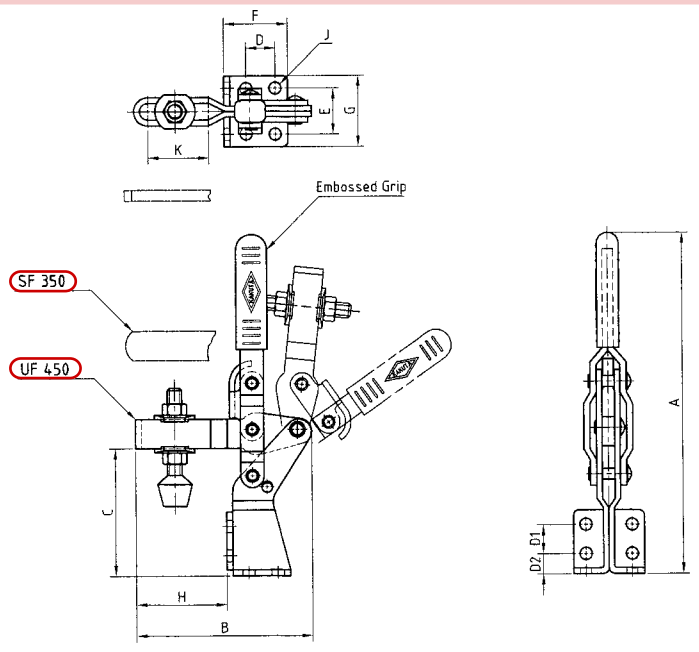

Model	A	B	C	D	D1	D2	E	F	G	H	J	K	Holding Capacity	Shipping Weight	Handle Moves	Bar moves
SF 350	187.2	103	70	16	16	11	25.4	35	39	55	6.7	-	170 Kg	398 g	60°	96°
UF 450	187.2	96.7	70	16	16	11	25.4	35	39	49.7	6.7	33.5	170 Kg	398 g	60°	96°

No. 82 No. 82-S

Each model has two mounting areas, horizontal and vertical surfaces. Bar is cleared from work area when opened. The red embossed handle grips are included. No. 82, U-Bar model is supplied with flanged washers and spindle assembly. Solid Bar model, No. 82-S is furnished with bolt retainer and spindle assembly.

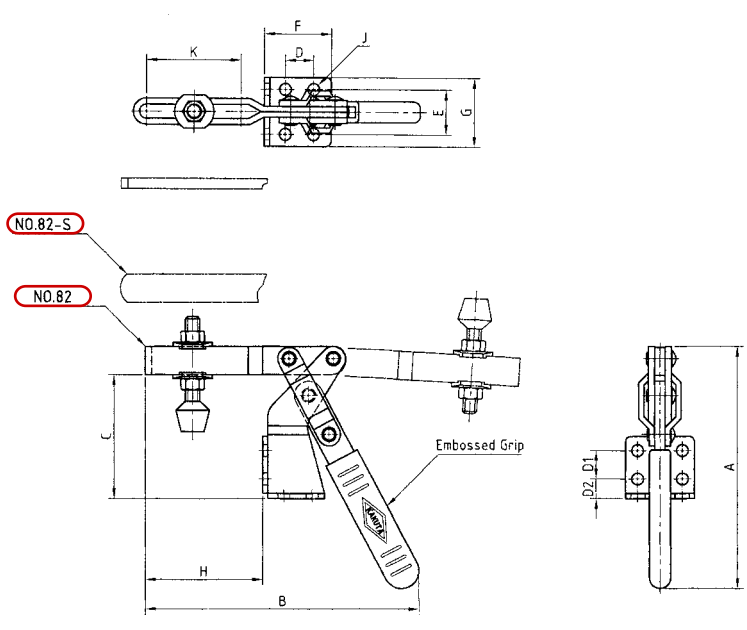
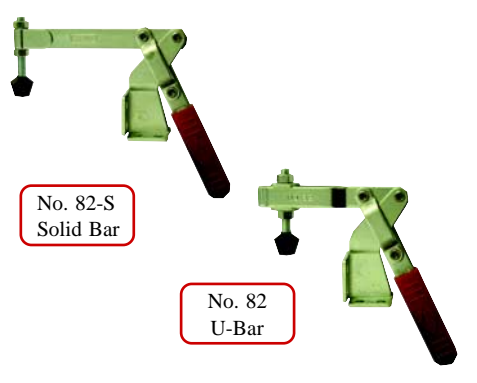

Model	A	B	C	D	D1	D2	E	F	G	H	J	K	Holding Capacity	Shipping Weight	Handle Moves	Bar moves
No. 82	136.7	154.2	70	16	16	11	25.4	35	39	65.8	6.7	50	100 Kg	396 g	60°	96°
No. 82-S	136.7	168.4	70	16	16	11	25.4	35	39	80	6.7	-	100 Kg	433 g	60°	96°

Special Hold Down Clamp



HOLD DOWN ACTION

No. 38 B(S)
No. 38 B(L)

Both special hold down models are equipped with embossed red handle grips for secure holding purpose. Furnished with hex head spindle assembly and two flanged washers. Available in two sizes, small(S) and large(L). Straight Base models are also available.

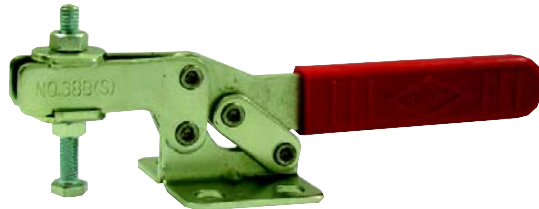

No. 38 S(S)
Straight Base

No. 38 S(L)
Straight Base

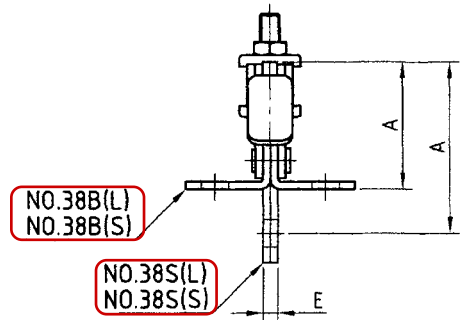
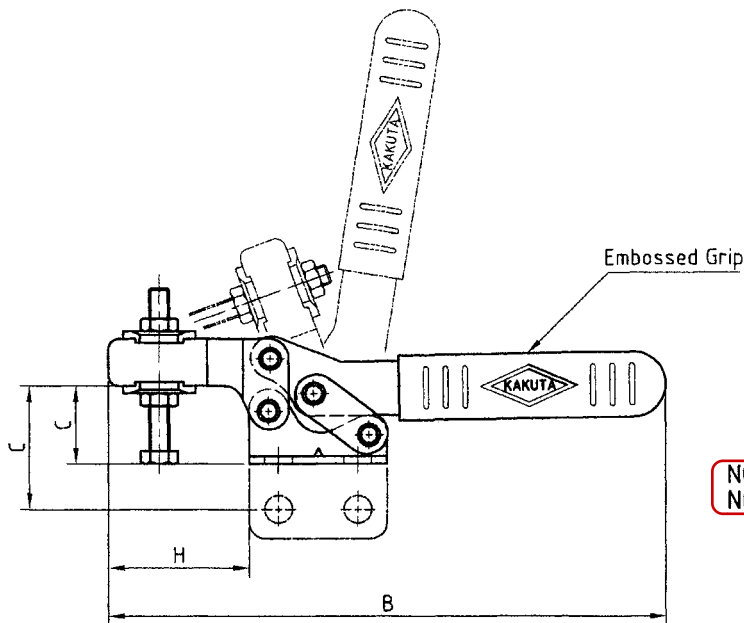
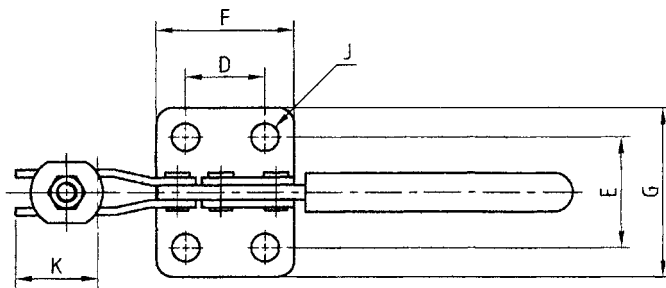

Model	A	B	C	D	E	F	G	H	J	K	Holding Capacity	Shipping Weight	Handle Moves	Bar moves
No. 38B(S)	39.2	170.9	24	24	34	42	52	43.2	8.5	25.4	250 Kg	200 g	70°	75°
No. 38S(S)	53.2	170.9	38	24	4.6	42	-	43.2	8.5	25.4	250 Kg	200 g	70°	75°
No. 38B(L)	57.9	238.9	37	30	37	57	57	85	10.5	55	280 Kg	490 g	80°	80°
No. 38S(L)	71.6	238.9	50	30	6.4	57	-	85	10.5	55	280 Kg	490 g	80°	80°

Special Hold Down Clamp



HOLD DOWN ACTION

No. 42A No. 42P

Medium vertical handle clamps are furnished with hex head spindle assembly and two flanged washers. No. 42A and 42K are included red vinyl grip. No. 42P and 42S are designed in T-Handle without vinyl grip. Straight Base models are also available for both models. Stainless steel models are available for No. 42A and No. 42K and furnished with hex head spindle assemblies.

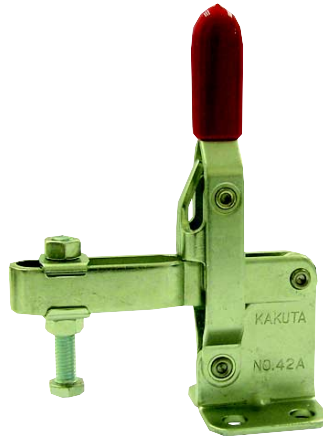

No. 42A



No. 42P
T-Handle

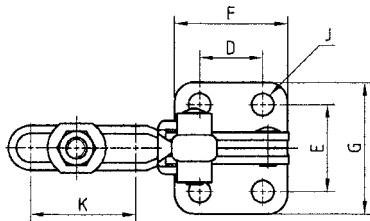

Vinyl Grip

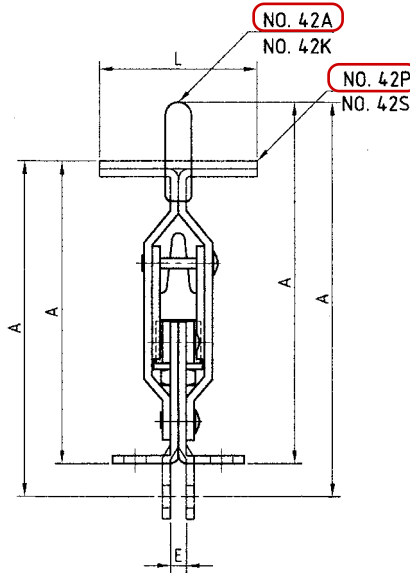
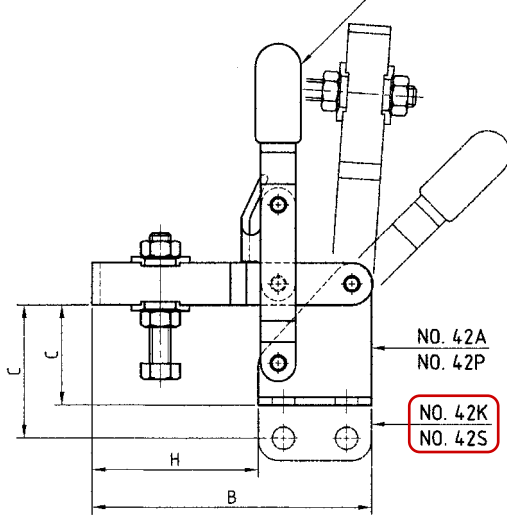

No. 42K
Straight Base

No. 42S
T-Handle/Straight Base

Also Available in
Stainless Steel
No. 42A-2S
No. 42K-2S

Model	A	B	C	D	E	F	G	H	J	K	L	Holding Capacity	Shipping Weight	Handle Moves	Bar moves
No. 42A	137.2	106	38	24	33	43	50	63	8.5	40	-	150 Kg	390 g	45°	94°
No. 42K	149.7	106	50.5	24	6	43	-	63	8.5	40	-	150 Kg	390 g	45°	94°
No. 42P	114.9	106	38	24	33	43	50	63	8.5	40	60	150 Kg	390 g	45°	94°
No. 42S	135.9	106	50.5	24	6	43	-	63	8.5	40	60	150 Kg	390 g	45°	94°

Latch Type



PULL/FASTEN ACTION

PA 150
PA 170

Both are Latch Type Pull Action clamps. The stopper can be set for handle traveling. PA 150 furnished with embossed red handle grip but PA 170 furnished with red vinyl grip.

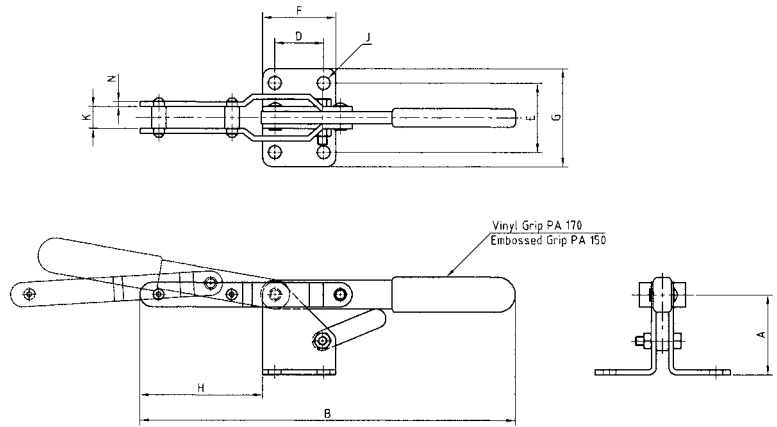

Model	A	B	D	E	F	G	H	J	K	N	Holding Capacity	Shipping Weight	Drawing Movement
PA 150	41.3	223	19	31.8	35	45	78	7.1	14.2	3.2	170 kg	340 kg	101.6
PA 170	52.3	246	32	45.2	48	64.2	80	8.3	14.2	3.2	545 kg	530 kg	84.5

PA 250
PA 251-B
PA 270
PA 350

The hook type of this clamp hangs a fixture and clamps by pulling. The bar is tapped so that length of the bar can be adjusted. Red vinyl handle grip provided for handle comfort. Stainless steel models are also available except PA 270 and PA 350.



Also Available in
Stainless Steel
PA 250-2S
PA 251-B2S

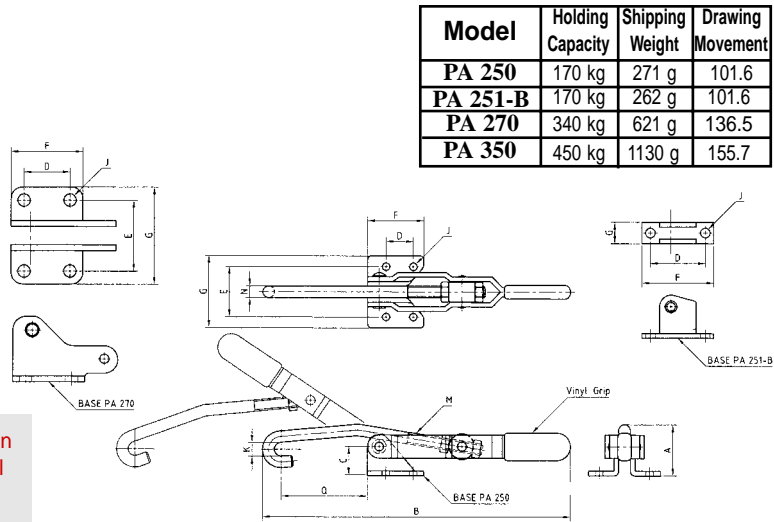

Model	Holding Capacity	Shipping Weight	Drawing Movement
PA 250	170 kg	271 g	101.6
PA 251-B	170 kg	262 g	101.6
PA 270	340 kg	621 g	136.5
PA 350	450 kg	1130 g	155.7

Model	A	B	C	D	E	F	G	J	K	M	N	Q Min	Q Max
PA 250	35	214	20	19	35	39	50	5.2	9.5	M8 X 1.25P	7.9	52.1	60
PA 251-B	35	214	20	38.2	-	50	14.7	5.2	9.5	M8 X 1.25P	7.9	39.9	47.8
PA 270	54.6	319	36	32	49.2	50	67.2	8.7	12.7	M8 X 1.5P	9.9	72.2	89.7
PA 350	67	358.3	46	28.5	60.5	54	86	10.3	16	M8 X 1.75P	11.9	59.8	78.8

Latch Type



PULL/FASTEN ACTION

- FA 100**
- FA 200**
- FA 300**

Ideal for light and medium duty application. Red vinyl handle grip provided for secure holding purpose. Each model furnished with latch plate. Stainless steel models also available.



FA 200

Model	Holding Capacity	Shipping Weight	Drawing Movement
FA 100	106 Kg	70 g	29
FA 200	320 Kg	215 g	40.5
FA 300	900 Kg	620 g	63

Also Available in Stainless Steel

- FA 100-2S
- FA 200-2S
- FA 300-2S

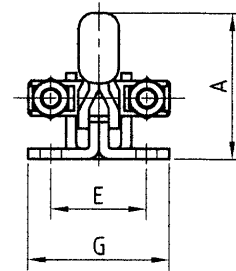
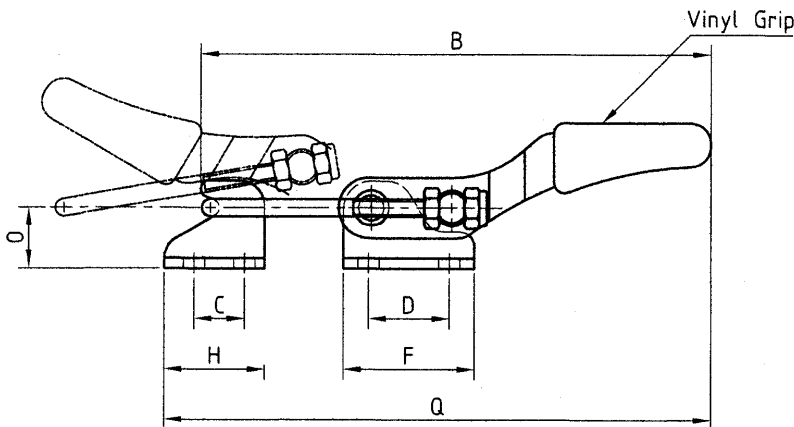
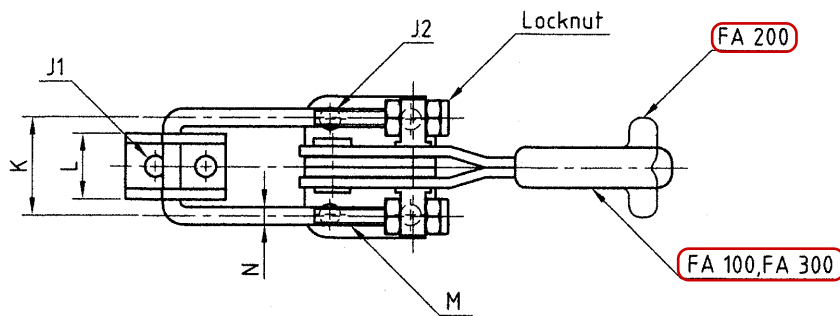

Model	A	B	C	D	E	F	G	H	J1	J2	K	L	M	N	O	Q Min	Q Max
FA 100	29	101	10	16	19	26	27.8	20	4.2	4.2	19	13	M4x0.7P	3.5	12	96	108.5
FA 200	49.8	148.4	14.3	19	32	41	44.5	26	6.8	6.8	25.4	17.5	M5x0.8P	4.8	16	144.4	159.4
FA 300	75	215	19	41.3	38	60.5	54	38	8.5	8.5	44.5	30.2	M8x1.25P	7.9	23.4	211	230

Latch Type



PULL/FASTEN ACTION

FA 102
FA 202
FA 302

Designed in three different sizes similar to FA 100-200-300. Supplied with latch plate. Red vinyl handle grip is included. Stainless steel models are available FA 102 and FA 202.



Model	Holding Capacity	Shipping Weight	Drawing Movement
FA 102	140 Kg	110 g	16
FA 202	250 Kg	300 g	24
FA 302	450 Kg	710 g	32

Also Available in
Stainless Steel

FA 102-2S
FA 202-2S

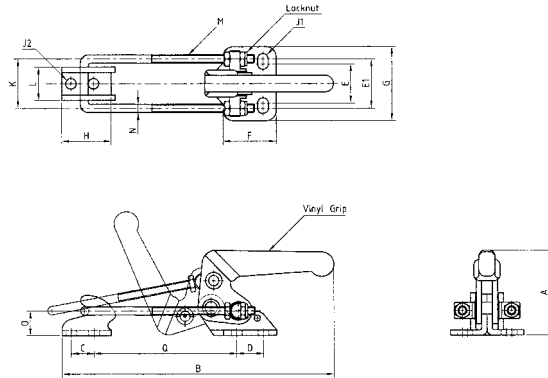

Model	A	B	C	D	E	E1	F	G	H	J1/SLOT	J2	K	L	M	N	O	Q Min	Q Max
FA 102	41.3	132.4	11	13	19	24	26	36	26	5.2X7.7	5.2	24	16.2	M4X0.7	3.5	12	38	70
FA 202	66.4	185.2	14	19	25	32	35	48	35.2	6.5X10	6.5	31	17.5	M6X1.0	5.8	19	48	90
FA 302	85	247.6	19	32	36	45	51	65	40	8.5X13	8.5	42	28	M8X1.25	7.9	25	65	120

FA 130
FA 230
FA 330

Another pulling direction of latch clamp supplied with latch plate. Available in three different sizes. Red vinyl handle grip provided for FA 130 and embossed red handle grips for FA 230 and FA 330. Stainless steel models also available except FA 330.



Model	Holding Capacity	Shipping Weight	Drawing Movement
FA 130	227 Kg	115 g	38.9
FA 230	454 Kg	270 g	50.8
FA 330	907 Kg	680 g	63.5

Also Available in
Stainless Steel

FA 130-2S
FA 230-2S

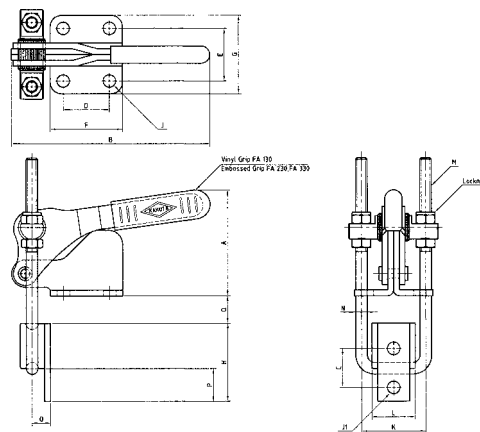

Model	A	B	C	D	E	F	G	H	J	J1	K	L	M	N	O	P	Q Min	Q Max
FA 130	51	80.5	14.3	12.7	22	25.4	35	25.5	5.2	4.3	20.5	13.5	M4x0.7P	3.5	4.7	11.8	12.2	25
FA 230	63.7	110.4	20.6	19	25.4	33.5	40	38	7.2	5.3	28	17.4	M6x1.0P	5.9	8.6	17.5	13.6	36
FA 330	73.5	137.5	27	32	36.5	50	54.5	54	8.7	8.7	44.5	30	M8x1.25P	7.9	12.7	22.8	19	51.8

Latch Type



PULL/FASTEN ACTION

FA 140
FA 240
FA 340

Lighter holding capacity than the above latch clamps supplied with latch plate. Stainless steel models are available except FA 340. Red vinyl grips are included.



Model	Holding Capacity	Shipping Weight	Drawing Movement
FA 140	140 kg	110 g	23
FA 240	250 kg	300 g	28
FA 340	450 kg	710 g	36

Also Available in
Stainless Steel

FA 140-2S
FA 240-2S

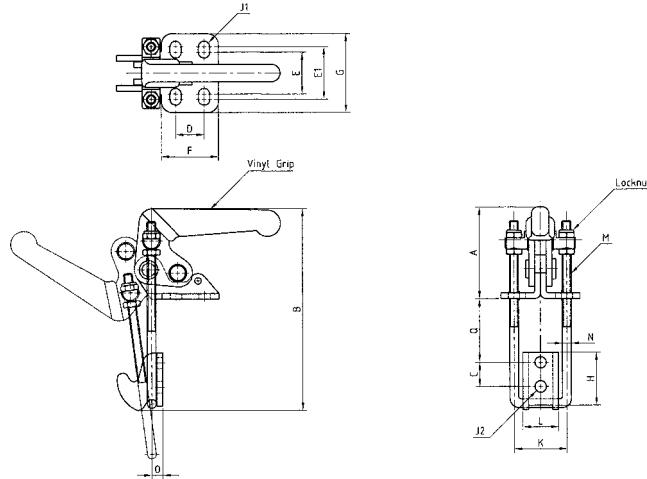

Model	A	B	C	D	E	E1	F	G	H	J1/SLOT	J2	K	L	M	N	O	Q Min	Q Max
FA 140	48	91.8	11	13	19	24	26	36	24	5.2x7.7	5.2	24	16.2	M4x0.7P	3.5	5	5	29
FA 240	63.6	121	14	19	25	32	35	48	35.2	6.5x10	6.5	31	17.5	M6x1.0P	5.8	7	6.5	35
FA 340	85	169.7	19	32	36	45	51	65	40	8.5x13	8.5	42	28	M8x1.25P	7.9	9	8	48

FA 600

Base of FA 600 is made by lost waxed steel. Red vinyl grip provided for handle comfort. Latch plate also made of wax casting and available as an optional accessory.



Model	Holding Capacity	Shipping Weight	Drawing Movement
FA 600	1815 Kg	1250 Kg	88.9

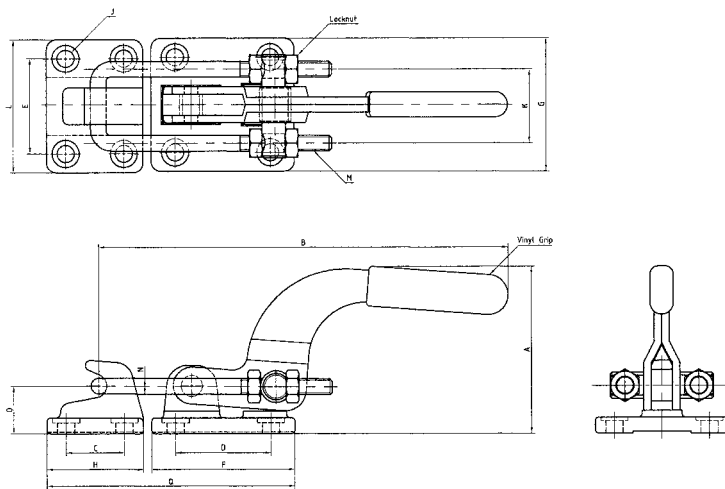

Model	A	B	C	D	E	F	G	H	J	K	L	M	N	O	Q Min	Q Max
FA 600	100.4	246	35	57.2	57.2	86	80	58	10.3	44.5	80	3/8-16	9.9	28.6	144	160

Latch Type



PULL/FASTEN ACTION

FA 601-B

This large latch clamp supplied with latch plate. Comfortable red vinyl handle grip also provided.



Model	Holding Capacity	Shipping Weight	Drawing Movement
FA 601-B	1815 Kg	1135 g	88.90

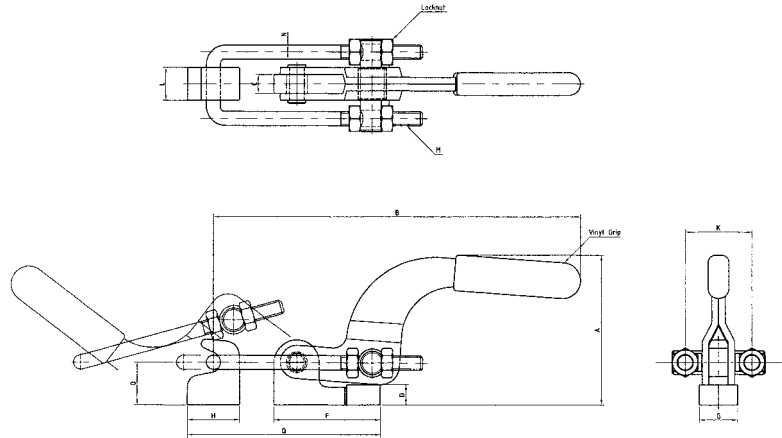

Model	A	B	C	D	F	G	H	K	L	M	N	O	Q Min	Q Max
FA 601-B	100.4	246	12.7	13.5	71	25.5	35	44.5	22	3/8-16	9.9	28.6	130	150

FA 700

Largest holding capacity of latch clamp. Latch plate is available as an optional accessory.



Model	Holding Capacity	Shipping Weight	Drawing Movement
FA 700	3400 g	1640 g	55.60

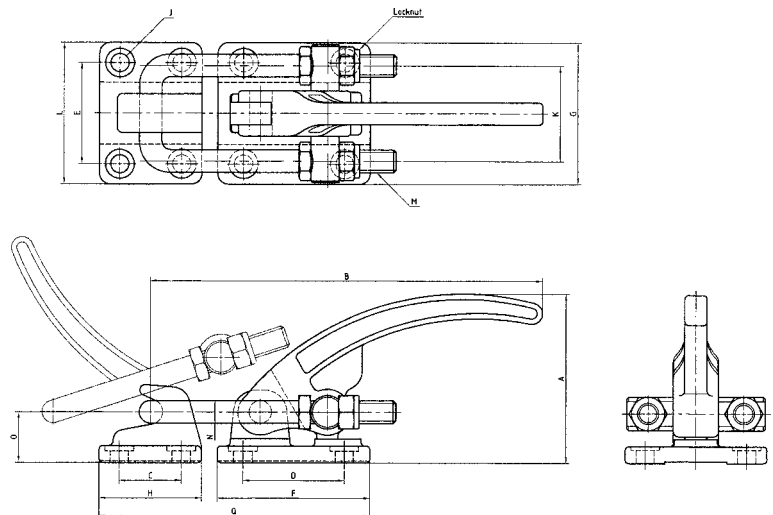

Model	A	B	C	D	E	F	G	H	J	K	L	M	N	O	Q Min	Q Max
FA 700	95.5	221.5	35	57.2	57.2	86	80	58	10.3	54	80	1/2-13	12.7	28.6	153	173

Push



STRAIGHT LINE ACTION

SL 07

This small Straight Line Action Clamp with horizontal handle is furnished with spindle assemblies. Handle is furnished with red vinyl-dipped grip.

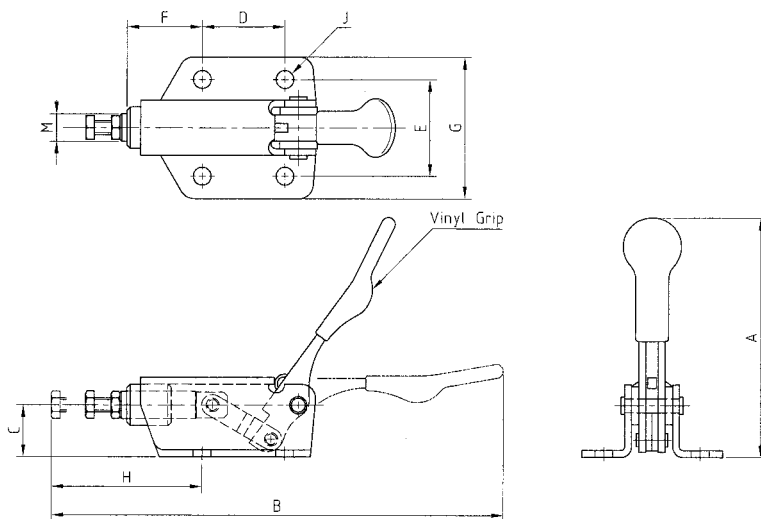

Model	A	B	C	D	E	F	G	H	J	M	Holding Capacity	Shipping Weight	Plunger Travel	Plunger Thread
SL 07	69.4	131.5	15	24	28	22	41	44	5.2	8	50 Kg	100 g	10	M4X0.70

SL 10 SL 15-2

Applicable for electronic fixturing and light duty. SL 10 furnished with spindle assemblies but stainless stssl model supplied with stainless steel hex head spindle. SL 15-2 is equipped with externally threaded plunger tip. Red vinyl handle grip is supplied.



Also Available in
Stainless Steel
SL 10-2S
SL 15-22S

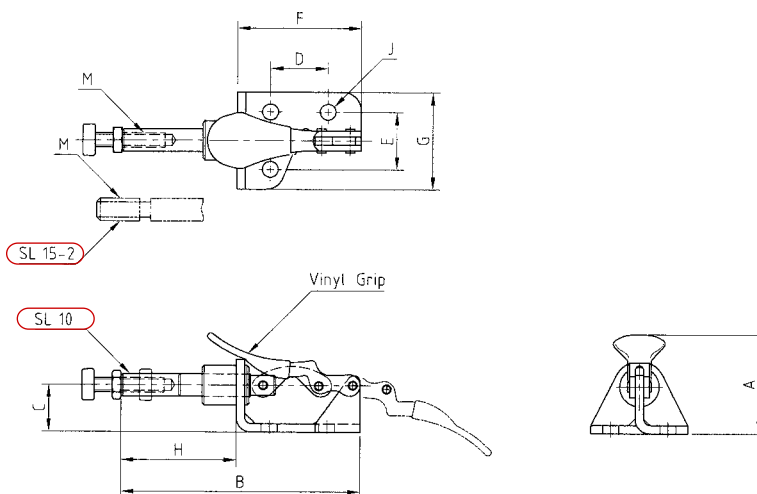

Model	A	B	C	D	E	F	G	H	J	M	Holding Capacity	Shipping Weight	Plunger Travel	Plunger Thread
SL 10	27.5	66.5	13	16	16	33.5	27	32	4.4	M4	45 Kg	40 g	16	M4X0.70
SL 15-2	27.5	73.5	13	16	16	33.5	27	39	4.4	M6	45 Kg	40 g	16	M6X1.00

Push



STRAIGHT LINE ACTION

SL 70

Small lost waxed steel base is required only a little mounting space. Supplied with red vinyl grip.

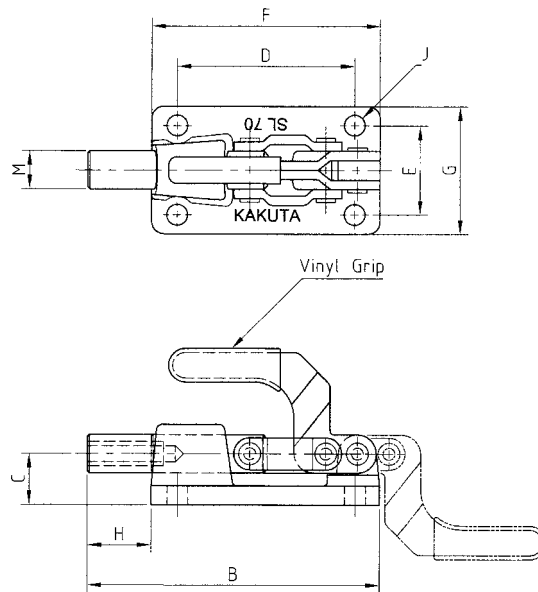
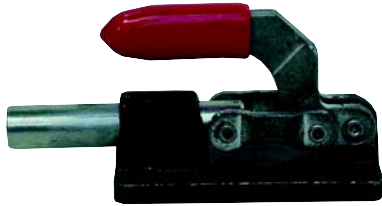

Also Available in
Stainless Steel
SL 70-2S

Model	A	B	C	D	E	F	G	H	J	M	Holding Capacity	Shipping Weight	Plunger Travel	Plunger Thread
SL 70	39	73	12.7	44.4	22.2	57.1	31.8	15.9	5.2	9.5	136 Kg	226 g	15.9	M6X1.0

SL 100 SL 200 SL 300

Body base is made of lost waxed steel except SL 300 composed of FCD. Red vinyl handle grip provided for SL 100 and SL 300 but embossed red handle grip for SL 200.

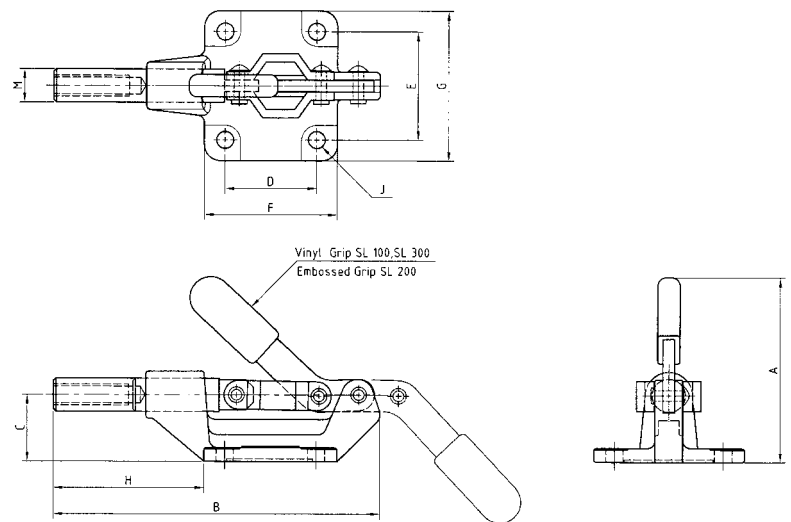
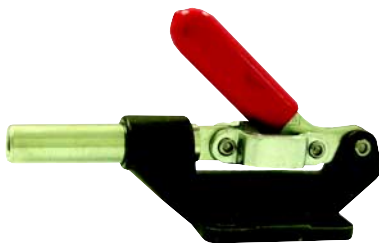

Model	A	B	C	D	E	F	G	H	J	M	Holding Capacity	Shipping Weight	Plunger Travel	Plunger Thread
SL 100	70.4	124.2	25.4	35	41.3	50.8	57.1	57.2	6.5	12.7	220 Kg	350 g	30.2	M8X1.25
SL 200	96.3	156	31.7	41.3	41.3	57.1	57.1	77	8.4	16	380 Kg	640 g	41.3	M10X1.5
SL 300	139	242	44.5	50.8	50.8	69.8	69.8	120	8.7	19	680 Kg	1430 g	61.9	M12X1.75

Push



STRAIGHT LINE ACTION

SL 105-2

Similar to SL 100 except hole pattern and height when at closed position. The body base is made of lost waxed steel. The embossed red handle grip is provided.

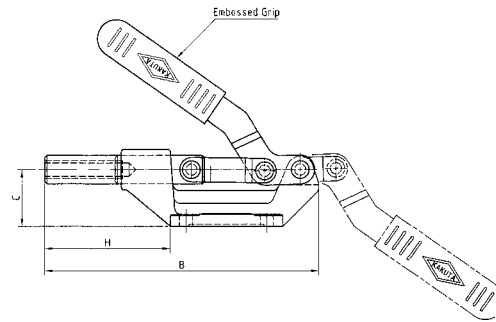
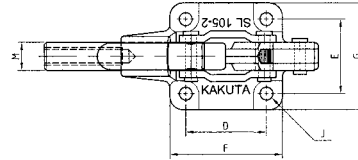
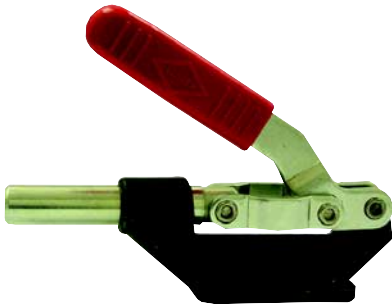

Also Available in
Stainless Steel
SL 105-22S

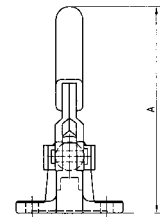

Model	A	B	C	D	E	F	G	H	J	M	Holding Capacity	Shipping Weight	Plunger Travel	Plunger Thread
SL 105-2	92.7	123.4	25.4	36.5	33.5	50.8	48	56.5	5.8	12.7	220 Kg	380 g	31.7	M8X1.25

SL 110 SL 111-B

This straight line action clamp supplied with red embossed handle grip. Straight base model, SL 111-B is also available.

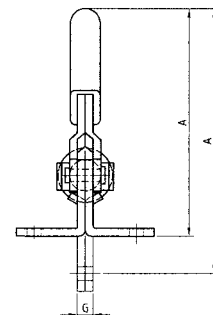
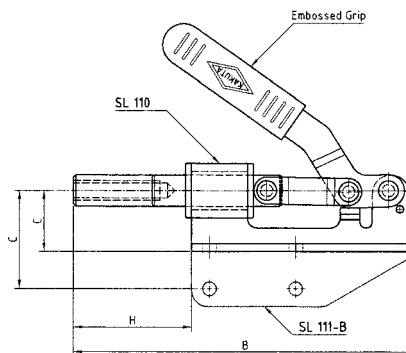
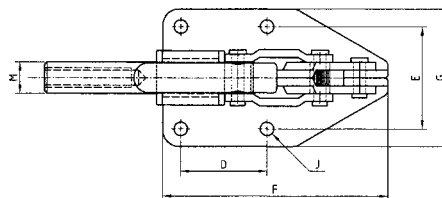

Model	A	B	C	D	E	F	G	H	J	M	Holding Capacity	Shipping Weight	Plunger Travel	Plunger Thread
SL 110	91.9	139	24.6	35	41.4	91.2	55.6	47.8	5.5	12.7	136 Kg	399 g	31.7	M8X1.25
SL 111-B	106.8	139	39.6	35	-	91.2	6.4	47.8	5.5	12.7	136 Kg	399 g	31.7	M8X1.25

Push



STRAIGHT LINE ACTION

SL150

This Push and Pull clamp is included red embossed handle grip.

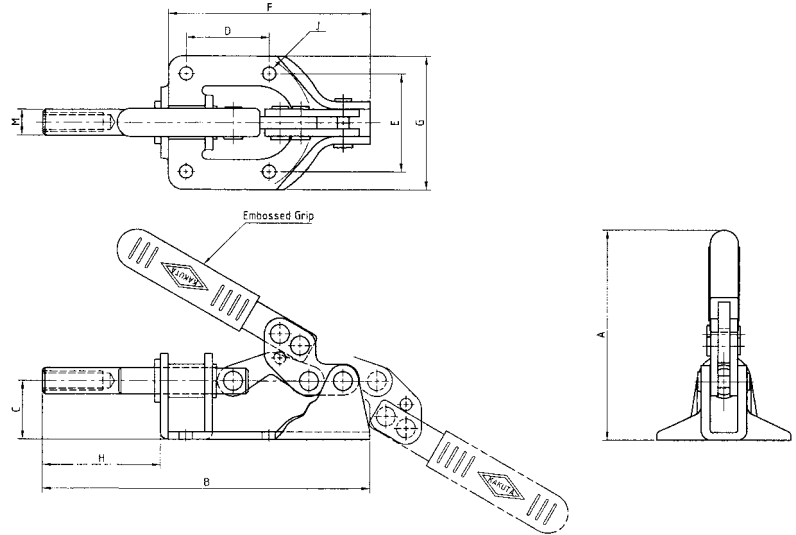

Model	A	B	C	D	E	F	G	H	J	M	Holding Capacity	Shipping Weight	Plunger Travel	Plunger Thread
SL 150	88.6	138.2	24.6	34.9	41.3	85.8	56.3	49.2	5.6	11	135 Kg	285 g	31.7	M8X1.25

SL 160

When opened, handle is in forward position that opposes direction from SL 150. Supplied with red embossed handle grip.

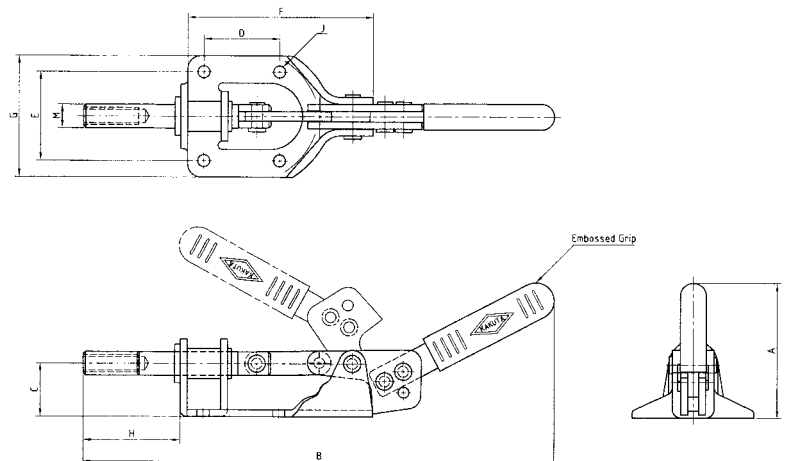

Model	A	B	C	D	E	F	G	H	J	M	Holding Capacity	Shipping Weight	Plunger Travel	Plunger Thread
SL 160	62.6	217.6	24.6	34.9	41.3	85.8	56.3	44.5	5.6	11	135 Kg	315 g	24.6	M8X1.25

Push



STRAIGHT LINE ACTION

SL 210

Identical to SL 200, except handle designed differently. Comfortable red embossed handle grip is furnished.

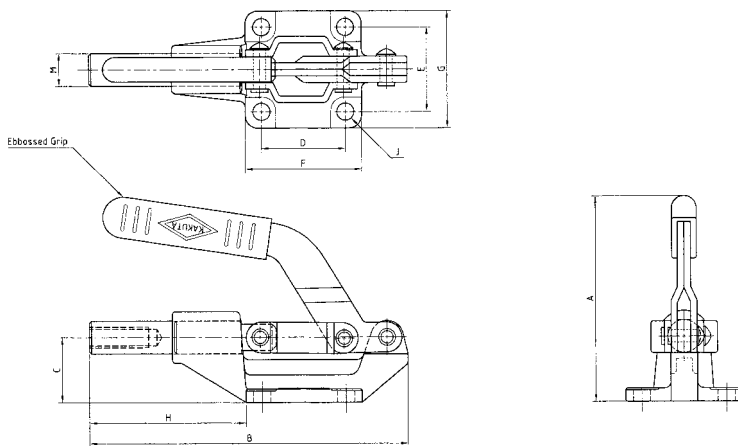
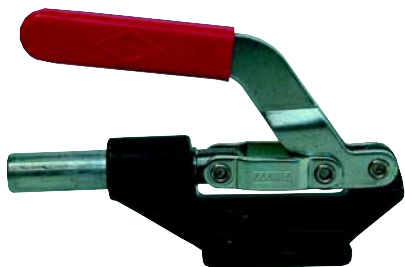

Model	A	B	C	D	E	F	G	H	J	M	Holding Capacity	Shipping Weight	Plunger Travel	Plunger Thread
SL 210	100.2	155.7	31.7	41.3	41.3	57.1	57.1	76.2	8.4	16	385 Kg	570 g	41.3	M10X1.5

SL 240 SL 241-B

Handle in horizontal lock position and plunger moves forward. Also available in straight base, SL 241-B with removable base bracket. Both are furnished with red embossed handle grips.



SL 240



SL 241-B

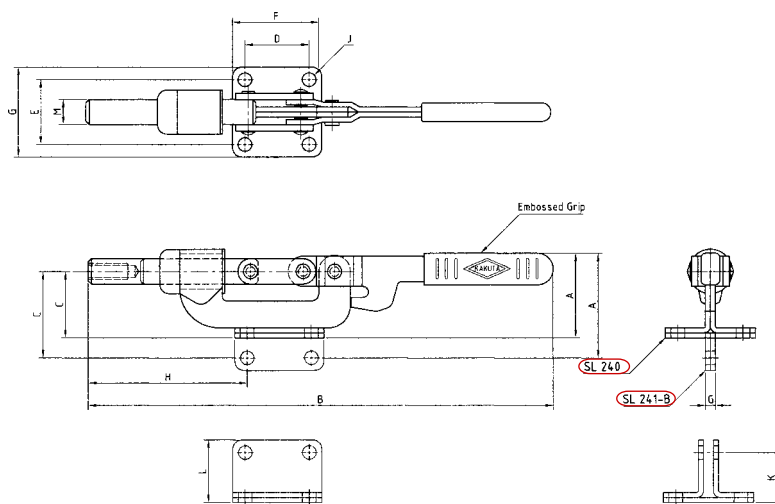

Model	A	B	C	D	E	F	G	H	J	K	L	M	Holding Capacity	Shipping Weight	Plunger Travel	Plunger Thread
SL 240	53.8	296	42.3	41.3	41.3	57.3	57.3	93	8.7	-	-	16	360 Kg	760 g	41.3	M10X1.50
SL 241-B	66.6	296	55.1	41.3	41.3	57.3	6.4	101	8.7	31.8	39.7	16	360 Kg	960 g	41.3	M10X1.50

Push



STRAIGHT LINE ACTION

SL 250 SL 251-B

Similar to SL 240. Handle in backward when clamps are in full open position. Red vinyl-dipped grips are included. SL 251-B, straight base is available with removable base bracket.

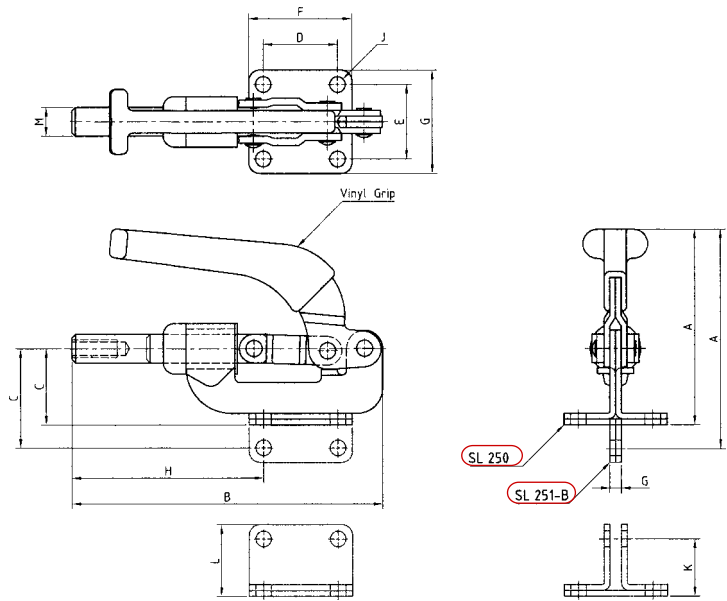

Model	A	B	C	D	E	F	G	H	J	K	L	M	Holding Capacity	Shipping Weight	Plunger Travel	Plunger Thread
SL 250	108.6	172.4	42.3	41.3	41.3	57.3	57.3	106.3	8.7	-	-	16	360 Kg	760 g	41.3	M10X1.5
SL 251-B	122.1	172.4	55.1	41.3	41.3	57.3	6.4	106.3	8.7	31.8	39.7	16	360 Kg	960 g	41.3	M10X1.5

SL 310 SL 350 SL 450

Base is made of forged alloy steel. SL 310 and SL 450 are supplied with base in black oxide plate but SL 350 in white zinc plate. Red vinyl-dipped handle included for secure handle purpose.

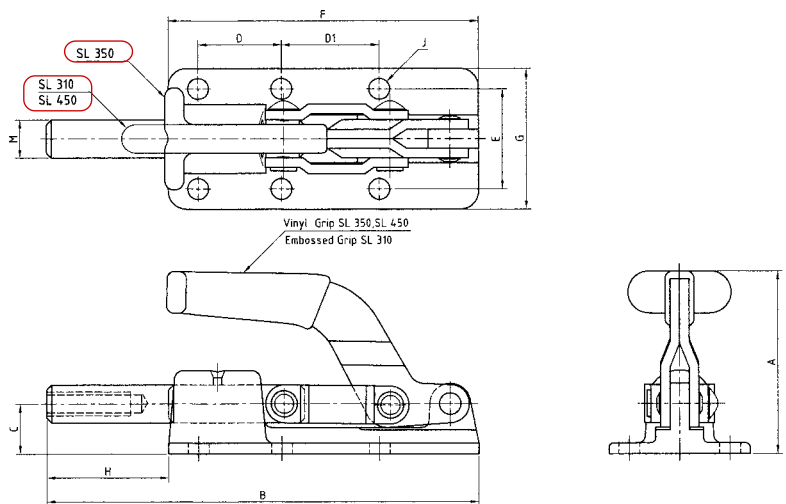
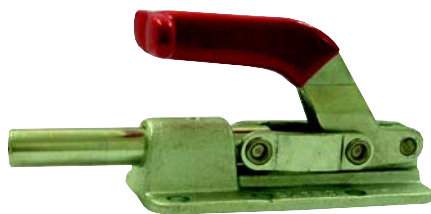

Model	A	B	C	D	D1	E	F	G	H	J	M	Holding Capacity	Shipping Weight	Plunger Travel	Plunger Thread
SL 310	89.4	154	17.5	35	41.5	41.5	107	56	47	7.2	12.7	360 Kg	650 g	42	M8X1.25
SL 350	76.6	181	21	35	41	42	130	59	51	8.8	16	1000 Kg	954 g	51	M10X1.5
SL 450	106	320	32	90.5	90.5	54	216	76	104	10.3	22	3000 Kg	3100 g	101.6	M12X1.75

Push



STRAIGHT LINE ACTION

NO. 02

Similar to No.51 but smaller in dimension and holding capacity. Furnished with comfortable red vinyl grip.

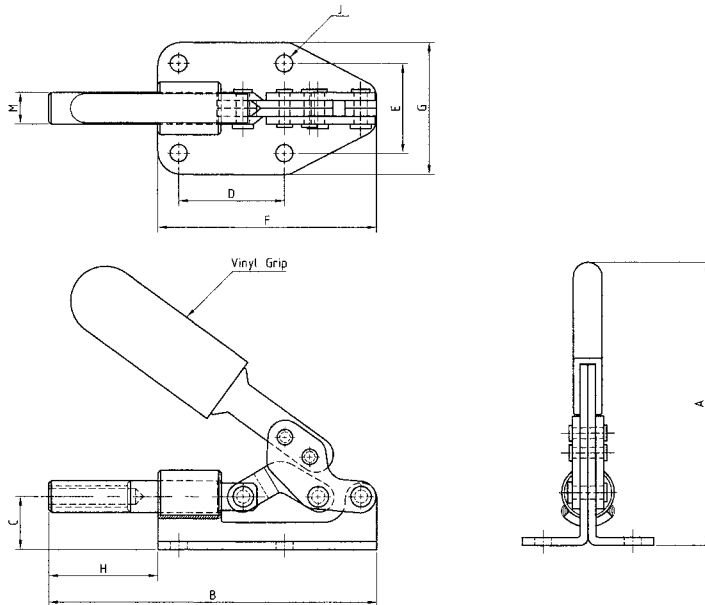
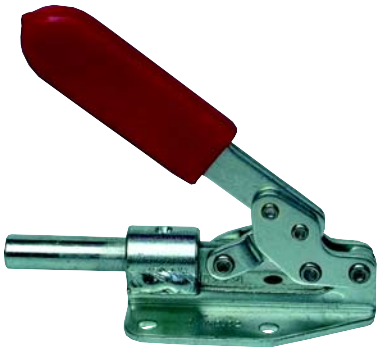

Model	A	B	C	D	E	F	G	H	J	M	Holding Capacity	Shipping Weight	Plunger Travel	Plunger Thread
NO. 02	107	124.5	20	40	34	83	50	41.5	6.5	12	200 Kg	330 g	30	M8X1.25

NO.51

Larger in dimension and capacity than No.02 and SL 150. Furnished with a hex head bolt and a nut. Equipped with red embossed handle grip for secure handle purpose.

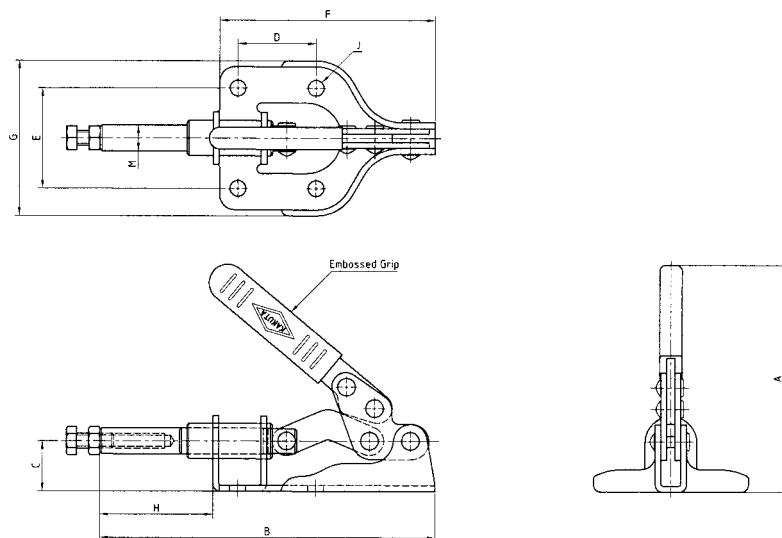

Model	A	B	C	D	E	F	G	H	J	M	Holding Capacity	Shipping Weight	Plunger Travel	Plunger Thread
NO. 51	122	180.5	27	42	54	116	83.5	61.5	8.5	14	220 Kg	500 g	43	M8X1.25

Flush Mounted



STRAIGHT LINE ACTION

FM 50
FM 150
FM 250

As these Flush Mounted Action clamps have free handle, clamping can be made at free position. It is widely applicable and workable for push and pull action. Equipped with red vinyl grip for FM 50 and red embossed handle grips for FM 150 and FM 250.

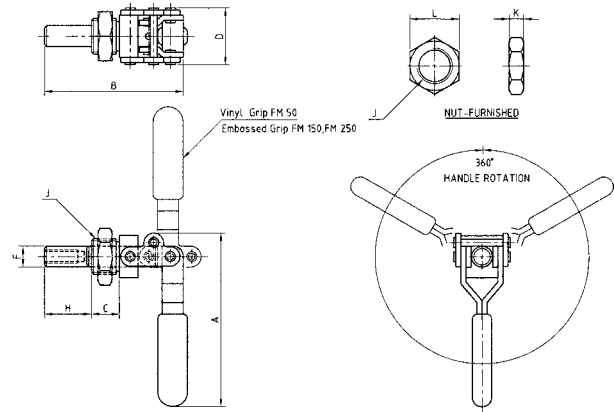

Also Available in
Stainless Steel
FM 50-2S
FM 150-2S

Model	A	B	C	D	F	H	J	K	L	Holding Capacity	Shipping Weight	Plunger Travel	Plunger Thread
FM 50	78	62	12.6	26.5	9.5	20.5	M16X1.50	6	22	90 Kg	103 g	19	M6X1.00
FM 150	107.8	107.3	15.9	31.6	11	38.4	M20X1.50	6	25.4	150 Kg	260 g	38.1	M8X1.25
FM 250	142	170.7	22.2	48.1	16	69.8	M27X2.00	6.4	38	320 Kg	757 g	66.7	M10X1.50

FM 150-1

This medium size of Flush Mounted Action clamp is similar to FM 150 but larger handle grip for operation comfort.

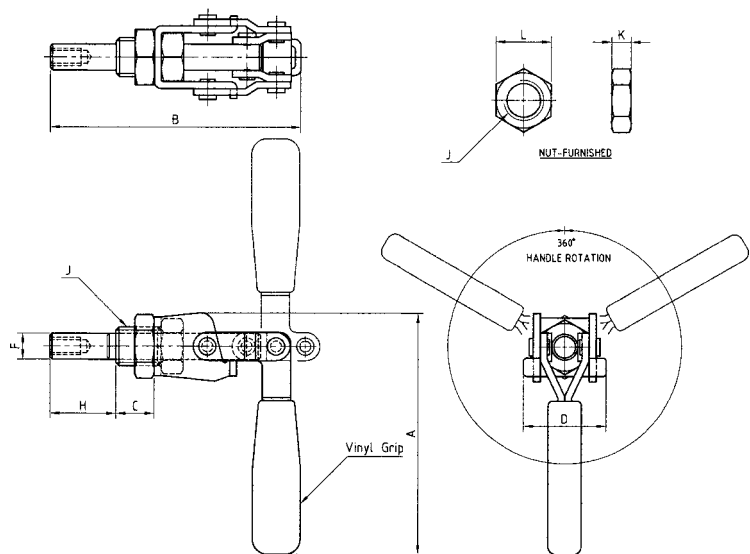
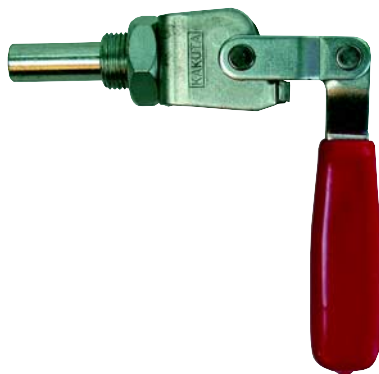

Model	A	B	C	D	F	H	J	K	L	Holding Capacity	Shipping Weight	Plunger Travel	Plunger Thread
FM 150-1	111	115.3	17.6	39	12	30.3	M18X1.50	9	25.4	150 Kg	380 g	26.3	M8X1.25

Plier



SQUEEZE ACTION

SA 2

Forged high carbon steel jaw moves 90°. Equipped with red embossed handle grip and hex head spindle.

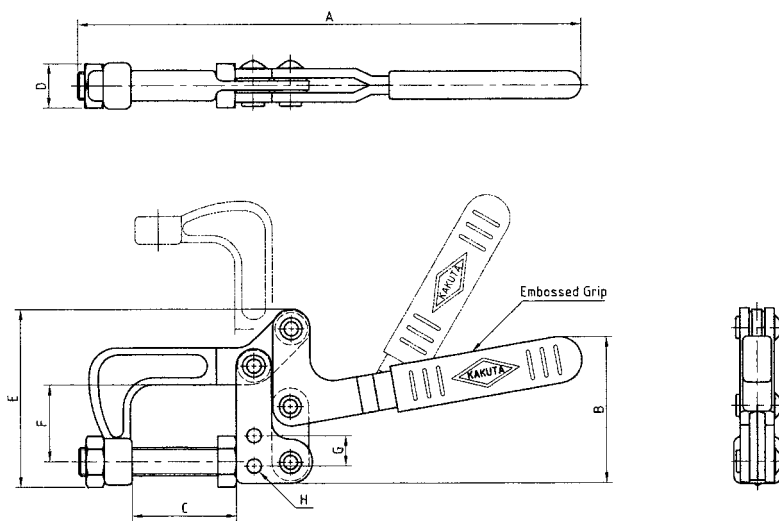
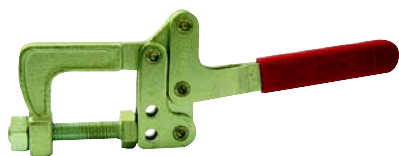

Model	A	B	C	D	E	F	G	H	Holding Capacity	Shipping Weight	Plunger Travel	Plunger Thread
SA 2	216.7	63	45	19	76.5	33	13	6.7	400 g	518 g	90°	50°

SA 150 SA 155-2

Forged steel clamp for small jobs requiring squeeze action. One vinyl coated spindle assembly is supplied with SA 150 but two vinyl coated spindle assemblies for SA 155-2.

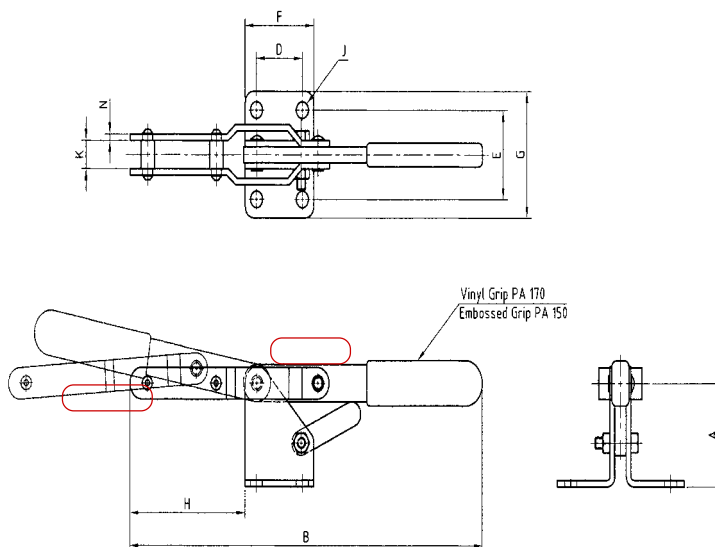

Model	A	B	C	D	E	F	Holding Capacity	Shipping Weight
SA 150	49.2	113.5	25.4	12.7	52.4	28.6	90 Kg	157 g
SA 155-2	49.2	113.5	25.4	12.7	52.4	28.6	90 Kg	157 g

Plier



SQUEEZE ACTION

SA 250 SA 255-2

Forged steel clamp is offering medium range holding pressure and compact size. SA 250 is furnished with one hex head spindle assembly. Two hex head spindle assemblies are supplied with SA 255-2.

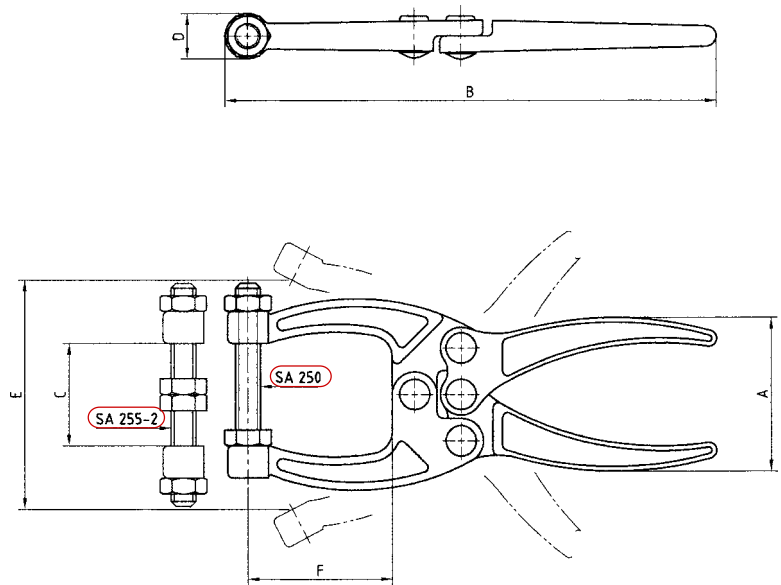

Model	A	B	C	D	E	F	Holding Capacity	Shipping Weight
SA 250	47.6	152.4	31.7	12.7	71.1	45	160 Kg	253 g
SA 255-2	47.6	152.4	31.7	12.7	71.1	45	160 Kg	253 g

SA 350

Compact, narrow jaw forged steel clamp for application in confined area. Fast open with two-way release lever. Supplied with a hex-head spindle assembly.

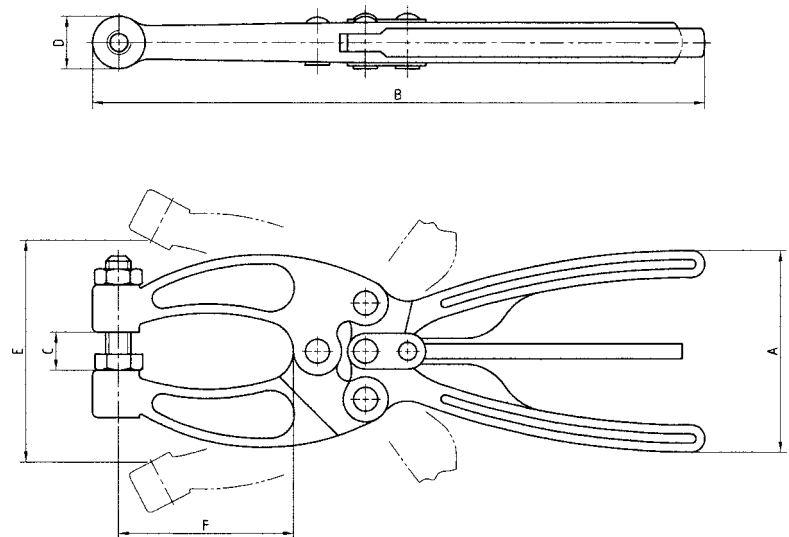

Model	A	B	C	D	E	F	Holding Capacity	Shipping Weight
SA 350	67	203	12.7	17.5	73	58	318 Kg	546 g

Plier



SQUEEZE ACTION

SA 450 SA 455-2

The most universal forged steel clamp in the line. Fast open with two-way release lever. SA 450 is equipped with a swivel foot assembly. SA 455-2 is supplied with two hex-head spindle assemblies.

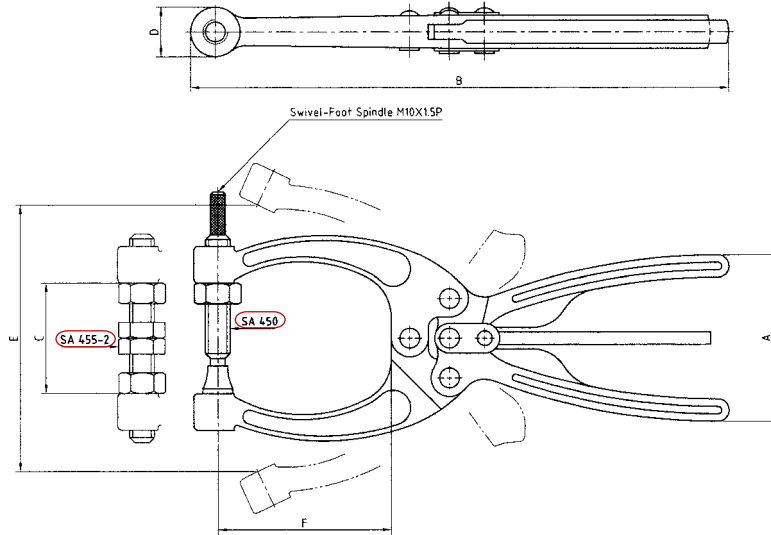

Model	A	B	C	D	E	F	Holding Capacity	Shipping Weight
SA 450	67	216	44.5	17.5	108	70	318 Kg	596 g
SA 455-2	67	216	44.5	17.5	108	70	318 Kg	596 g

SA 550

Made of forged steel for heavy duty application. Dual spindles to centralize jaws on work piece. Furnished with one swivel foot spindle assembly and one hex-head spindle assembly. Quick open with two-way release lever.

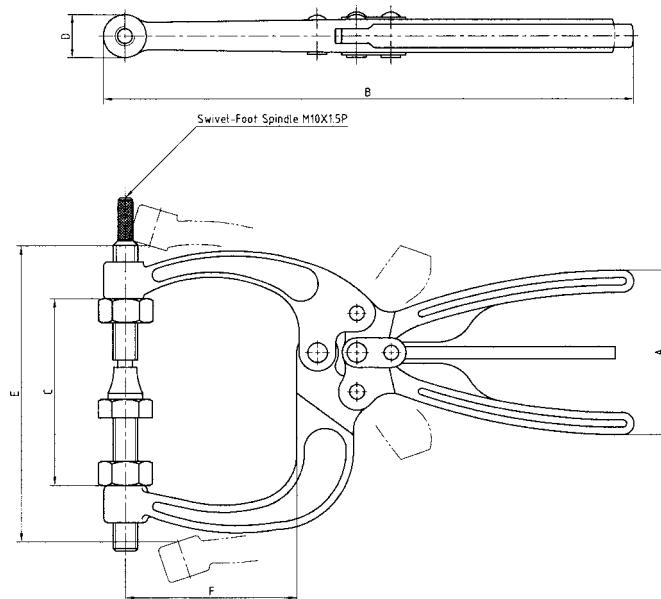

Model	A	B	C	D	E	F	Holding Capacity	Shipping Weight
SA 550	67	216	76	17.5	120.6	70	318 Kg	695 g

Vari Clamp (Heavy Duty Vertical Clamp)



HOLD DOWN ACTION

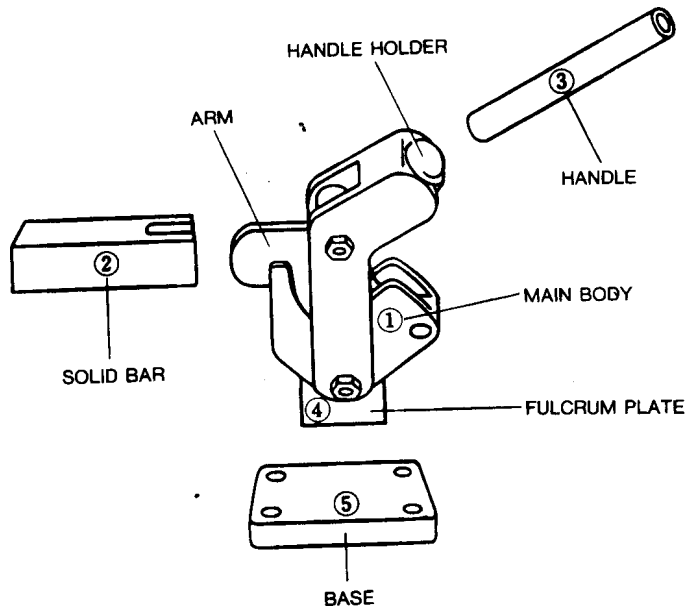

(APPLICATION FOR VARI-CLAMP)

The left figure shows that vari-clamp consists of handle, main body, base and solid BAR.

1. Determine the fixing point of main body.
2. Determine length of solid bar and weld it with arm.
3. Considering space between jig and clamp, determine height of handle and weld handle with handle holder.
4. Determine angle of main body and fulcrum plate and weld them.
5. Determine clamp fixing method to jig. In case of using the base, weld the base with fulcrum plate.

After assembling vari-clamp by the above steps, the vari-clamp becomes available.

*** As method of assembling vari-clamp can be decided in accordance with working conditions, vari-clamp is applicable widely and used at many working spots.*

*** As pin and bush composing fulcrum are finished by heat treatment (Hardness : H.R.C. 60) they are assembled so that abrasion is avoidable. Accordingly, vari-clamp is most suitable for jigs that are used frequently and required accuracy.*

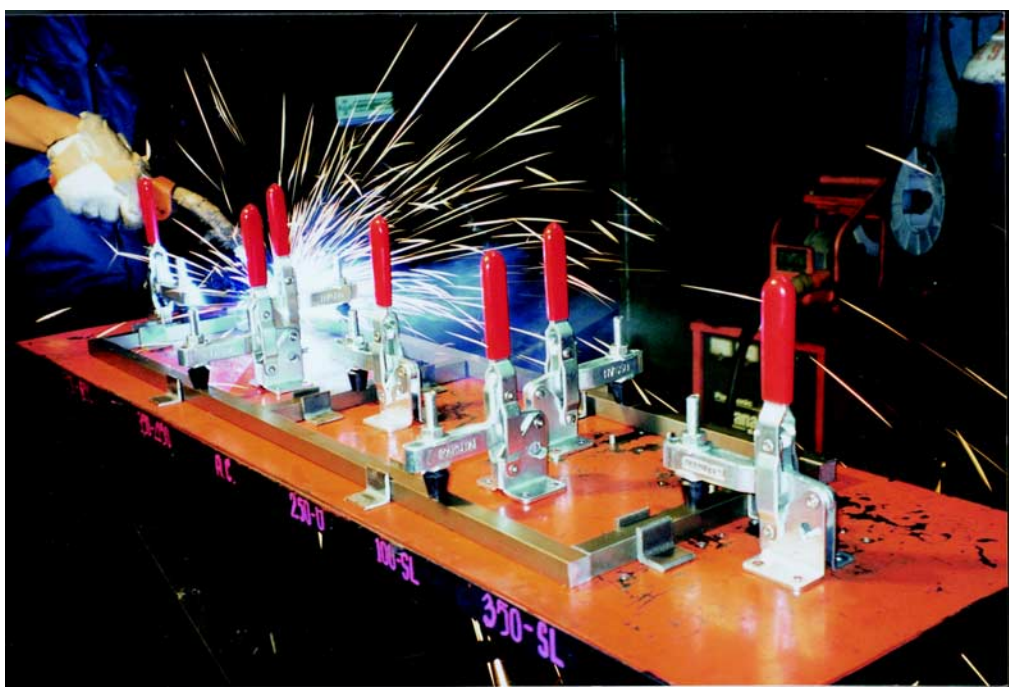

Vari Clamp (Heavy Duty Vertical Clamp)



HOLD DOWN ACTION

VARI No. 1
VARI No. 2
VARI No. 3

Designed for heavy duty work especially for automotive production line. Clamp furnished with base, arm and handle pipe as complete set for being weld to suit the application.

Raw Material: SS 41

Model	Holding Capacity	Shipping Weight	Handle Move	Bar Moves
VARI No. 1	200 Kg	845 g	116°	187°
VARI No. 2	500 Kg	2130 g	120°	200°
VARI No. 3	1000 Kg	4100 g	120°	200°

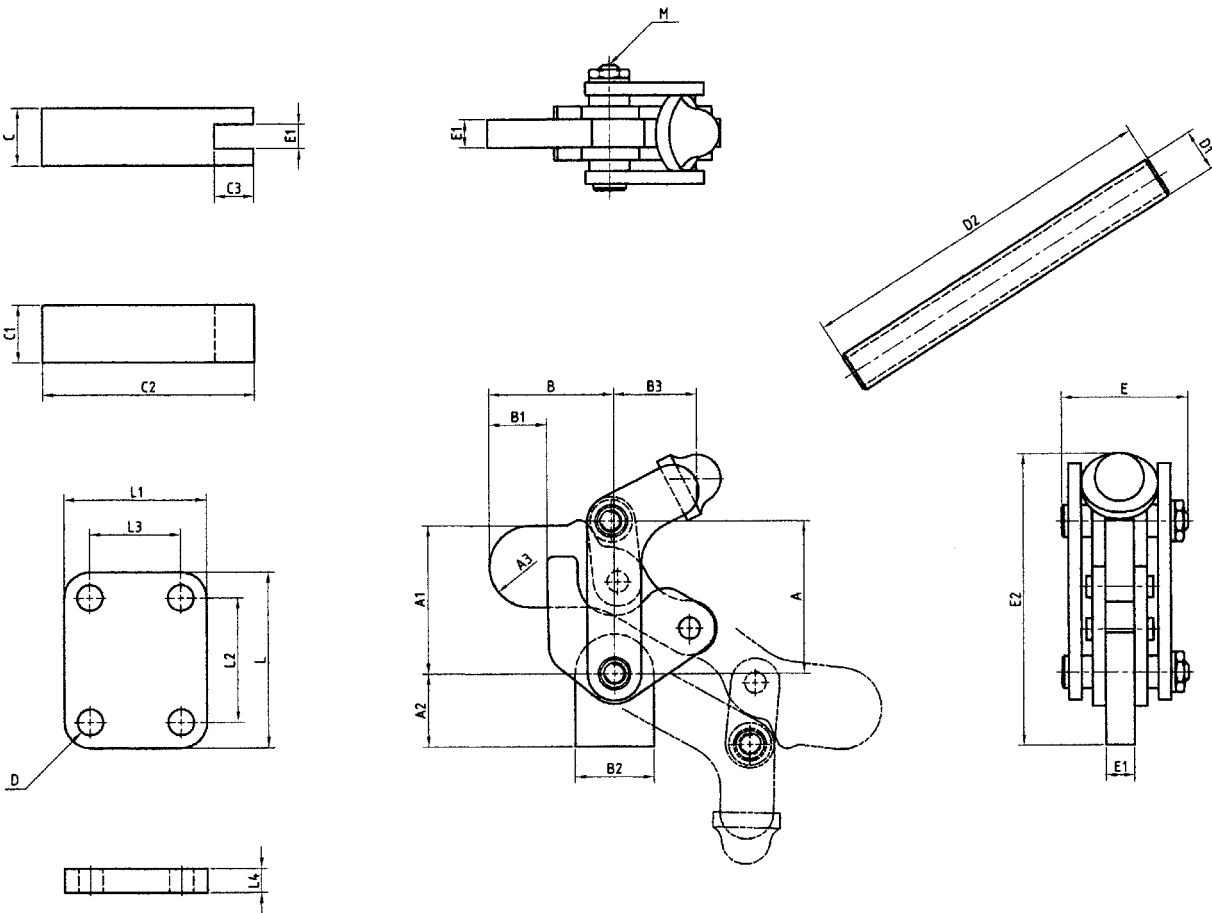

Model	A	A1	A2	A3	B	B1	B2	B3	C	C1	C2	C3	D	D1	D2	E	E1	E2	L	L1	L2	L3	L4	M
VARI No. 1	50	48.9	24	13.5	41.2	19	26	27.3	19	19	70	13	8.5	13.7	120	39	8	96.30	58	47	41	30	8	M6X1.00
VARI No. 2	70	76	32	22.5	50.5	23.7	35	32.6	25	25	100	23	11.5	22	137	58	13	135	80	60	60	40	11.5	M8X1.25
VARI No. 3	92	107.9	36	27	57	24	53	37.6	28	28	125	28	13.5	22	150	70	16	164.4	100	82	75	55	12	M10X1.50

Vari Clamp (Heavy Duty Vertical Clamp)



HOLD DOWN ACTION

VARI No. 1 SB VARI No. 2 SB

Identical to V. 1 and V. 2 except straight base.

Raw Material: SS 41

Model	Holding Capacity	Shipping Weight	Drawing Movement	Bar Moves
VARI No. 1SB	200 Kg	745 g	116°	187°
VARI No. 2SB	500 Kg	1940 g	120°	190°

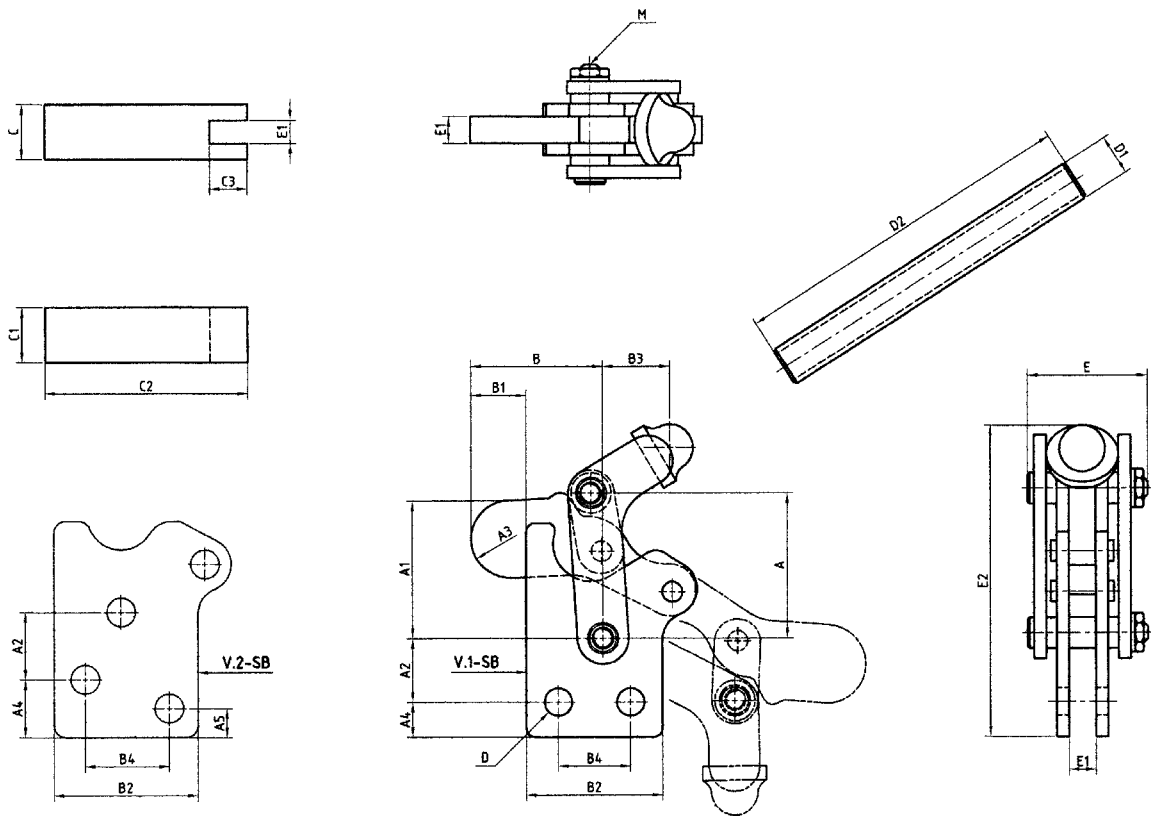
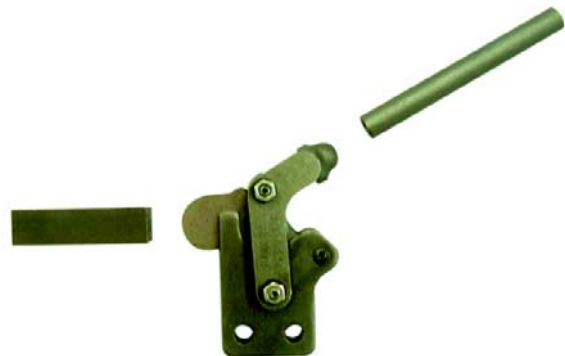

Model	A	A1	A2	A3	A4	A5	B	B1	B2	B3	B4	C	C1	C2	C3	D	D1	D2	E	E1	E2	M
VARI NO. 1SB	50	47.8	22	13.5	12	-	45.5	19	47	23.3	25	19	19	70	13	9.5	13.7	120	39	8	107.9	M6X1.00
VARI NO. 2SB	70	76	28	22.5	24	12	50.5	22.5	60	32.6	35	25	25	100	23	12	22	137	58	13	155	M8X1.25

Vari Clamp (Heavy Duty Vertical Clamp)



HOLD DOWN ACTION

VARI No. 1X
VARI No. 2X
VARI No. 3X

Larger series of heavy duty clamps. Base, arm and handle pipe are supplied with clamp as a set for being weld to suit the application.

Raw Material: SS 41

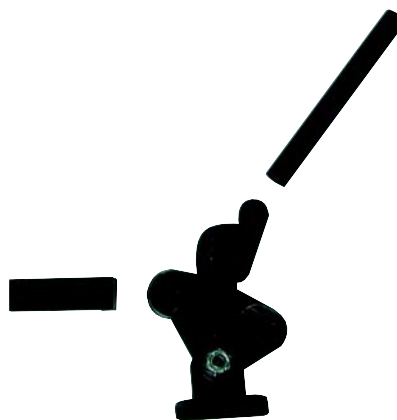

Model	Holding Capacity	Shipping Weight	Drawing Movement	Bar Moves
VARI No. 1X	340 Kg	350 g	130°	205°
VARI No. 2X	900 Kg	1100 g	130°	205°
VARI No. 3X	1360 Kg	2140 g	130°	205°

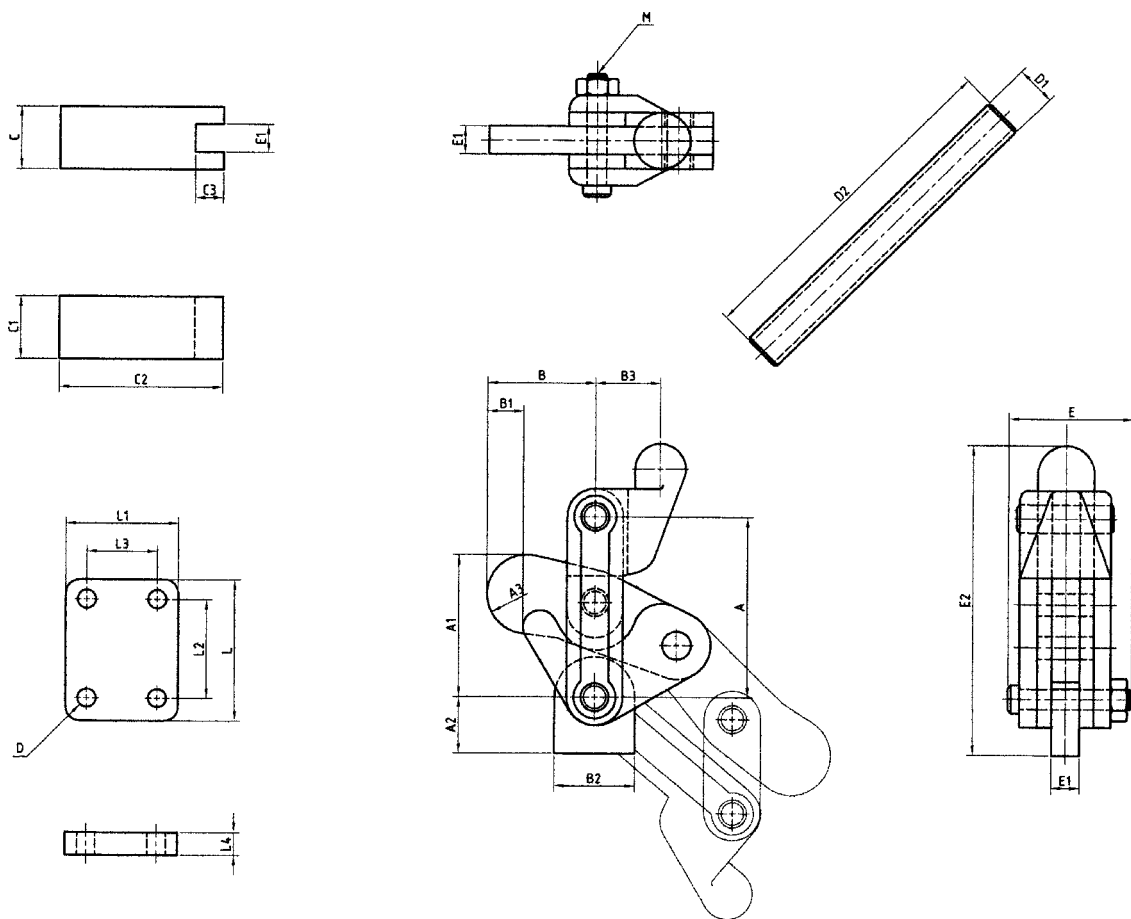

Model	A	A1	A2	A3	B	B1	B2	B3	C	C1	C2	C3	D	D1	D2	E	E1	E2	L	L1	L2	L3	L4	M
VARI No. 1X	40	32.7	10	10	30.7	13.8	18	14	16	16	50	10	5.5	12.7	50	28.2	6	65.5	35	28	25	18	6	M5X0.80
VARI No. 2X	64	50.4	20	14	38.4	12.8	28.6	23	22.2	22.2	58	10	6.5	13.7	120	47	10	110	50	40	35	25	8	5/16-18
VARI No. 3X	82.6	73	28	18	57	26.3	38	26.5	25	25	72	15	8.5	22	137	60.8	12.3	137.5	60	50	40	30	8	3/8-16

Vari Clamp (Heavy Duty Vertical Clamp)



HOLD DOWN ACTION

VARI No. 1X-B
VARI No. 2X-B
VARI No. 3X-B

Identical to V.1X, V.2X and V.3X except straight base.

Raw Material: SS 41

Model	Holding Capacity	Shipping Weight	Drawing Movement	Bar Moves
VARI No. 1X-B	340 Kg	330 g	130°	205°
VARI No. 2X-B	900 Kg	1100 g	130°	205°
VARI No. 3X-B	1360 Kg	2140 g	130°	205°

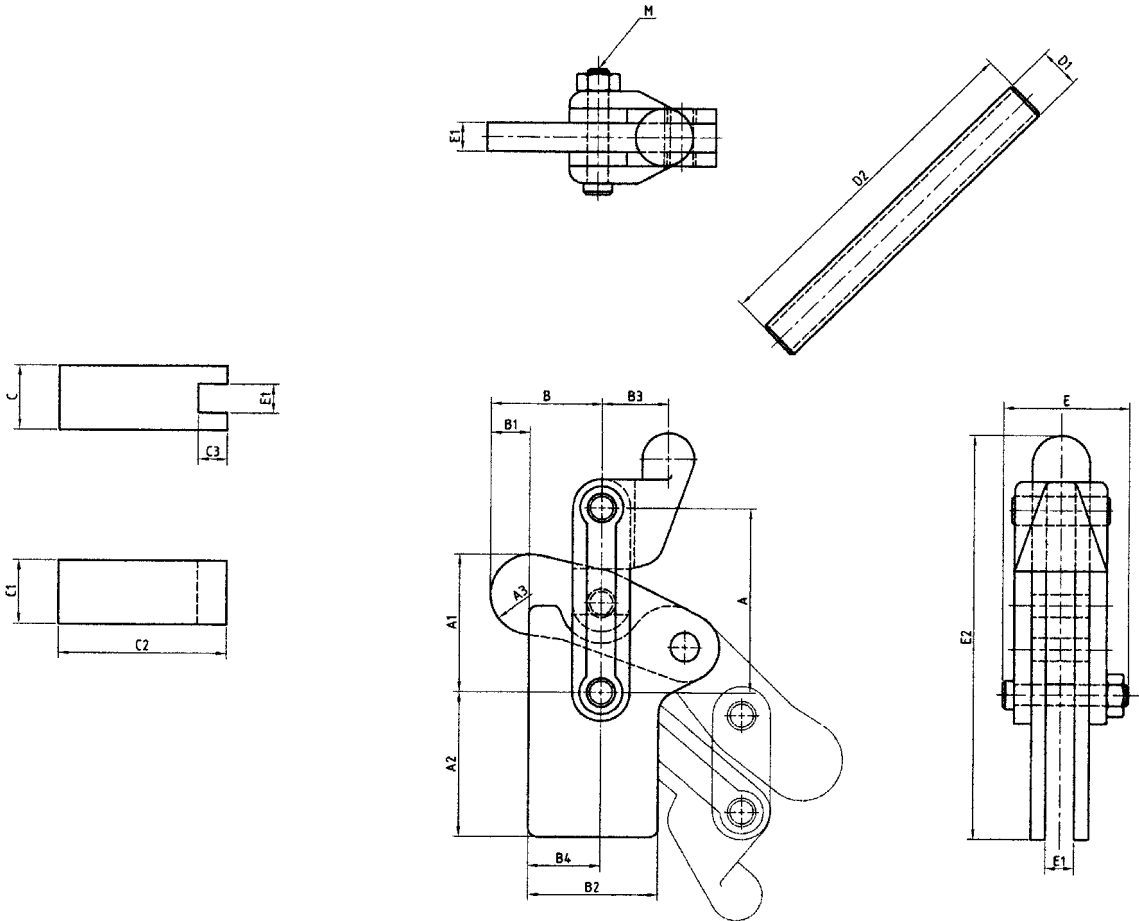
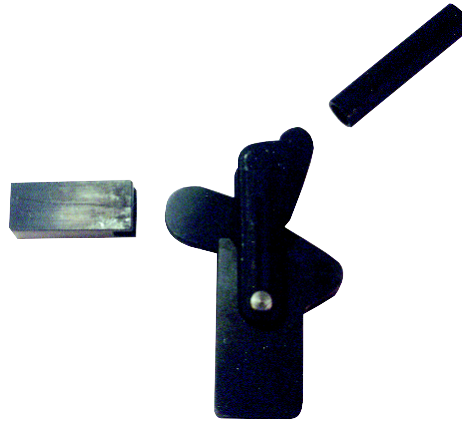

Model	A	A1	A2	A3	B	B1	B2	B3	B4	C	C1	C2	C3	D1	D2	E	E1	E2	M
VARI No. 1X-B	40	30	30	10	30.7	14.6	27	31.3	15	16	16	50	10	12.7	50	28.2	6	85.5	M5X0.80
VARI No. 2X-B	64	47.8	50	14	38.4	13.4	45	45	25	22.2	22.2	58	101	3.7	120	47	10	140	5/16-18.00
VARI No. 3X-B	82.6	73	63	18	57	32	50	45	25	25	25	72	15	22	137	60.8	12.3	172.5	3/8-16.00

Hold Down Action



AIR CLAMP

AC 250

The smallest hold down air clamp can be used to increase productivity. U-bar allows spindle position to be adjustable. Clamping action operated by air cylinder instead of by hand.

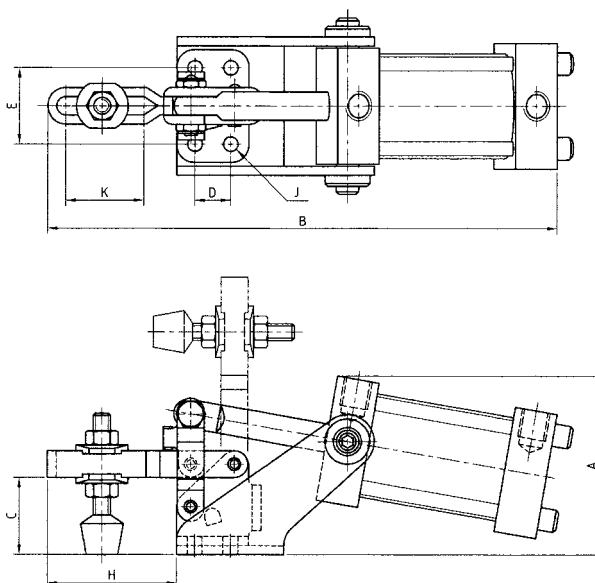

Model	A	B	C	D	E	H	J	K	Holding Capacity	Shipping Weight	Bar moves	Port Size
AC 250	63	180.5	27	12.7	27	44	5.2	27.5	90 Kg	534 g	90°	1/8 NPT

AC 350 AC 353-L

The medium size hold down air clamp available with solid bar, AC 350. A longer solid bar also available, AC 353-L. Furnished with bolt retainer and spindle assembly.

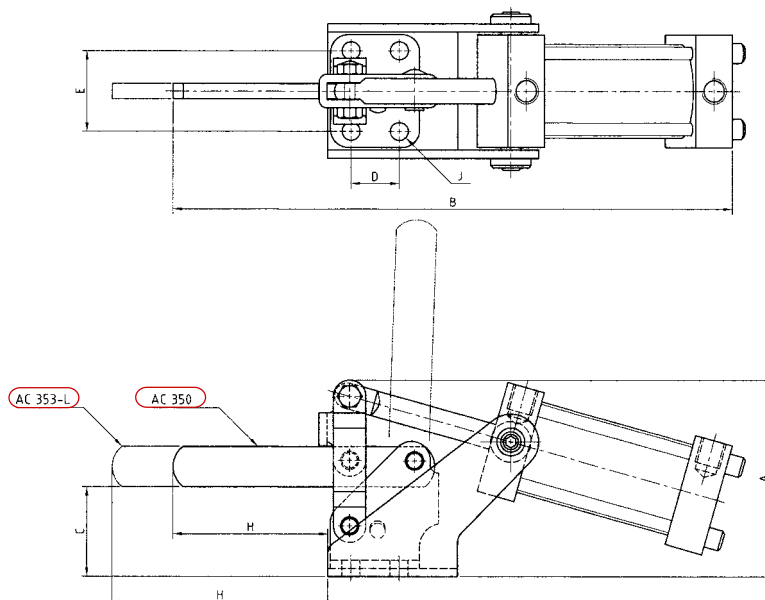

Model	A	B	C	D	E	H	J	Holding Capacity	Shipping Weight	Bar moves	Port Size
AC 350	77.4	220	35	19	31.8	61	7.1	225 Kg	787 g	92°	1/8 NPT
AC 353-L	77.4	244.4	35	19	31.8	85	7.1	110 Kg	787 g	92°	1/8 NPT

Hold Down Action



AIR CLAMP

AC 450 AC 453-L

Popular hold down air clamps available with U-bar, AC 450 and an extra long U-Bar, AC 453-L. Spindle position is adjustable.

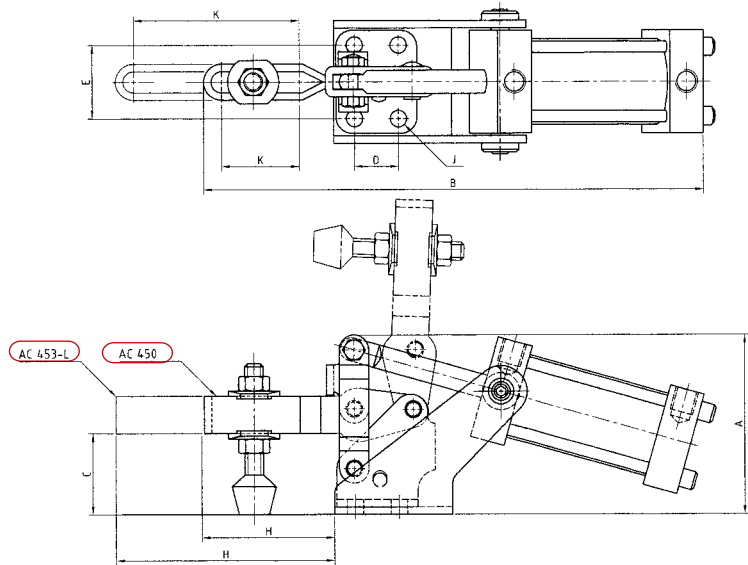

Model	A	B	C	D	E	H	J	K	Holding Capacity	Shipping Weight	Bar moves	Port Size
AC 450	77.35	215.6	35	19	31.8	56.2	7.1	33.5	225 Kg	787 g	92°	1/8 NPT
AC 453 -L	77.35	253.6	35	19	31.8	94.2	7.1	71.5	100 Kg	787 g	92°	1/8 NPT

AC 550

The larger hold down air clamp available with solid bar. Furnished with bolt retainer and spindle assembly.

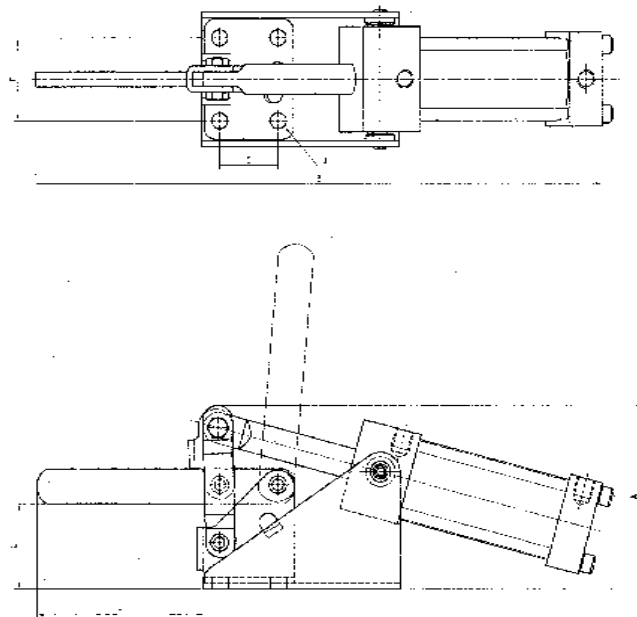

Model	A	B	C	D	E	H	J	K	Holding Capacity	Shipping Weight	Bar moves	Port Size
AC 550	97	307	46	31.8	45	90	8.7	-	340 Kg	1733 g	95°	1/8 NPT

Hold Down Action



AIR CLAMP

AC 650

This large hold down air clamp available with U-bar that allows spindle position to be adjustable.

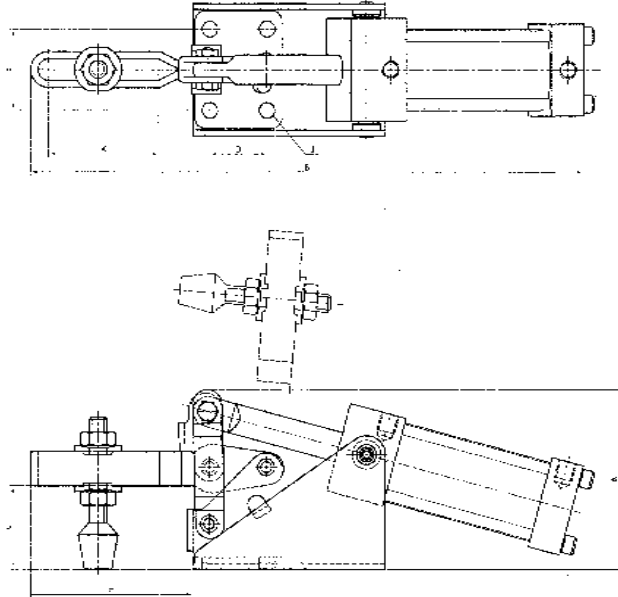
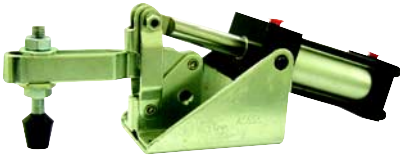

Model	A	B	C	D	E	H	J	K	Holding Capacity	Shipping Weight	Bar moves	Port Size
AC 650	97	307.00	46.00	31.80	45.00	90.00	8.70	61.00	272 Kg	1724 g	95°	1/8 NPT

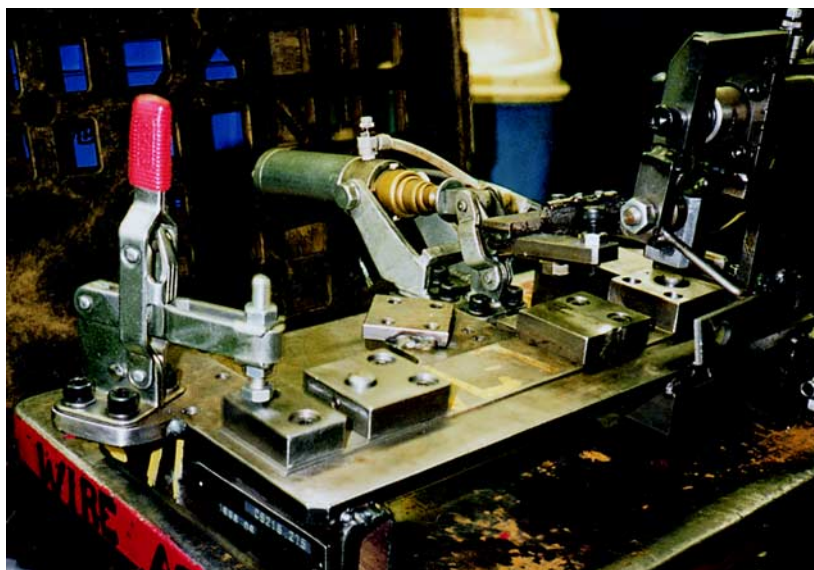

Straight Line Action



AIR CLAMP

AC 100-SL

Small size of straight line action air clamp.
Similar to SL 100 except operated by air
cylinder not by hand.

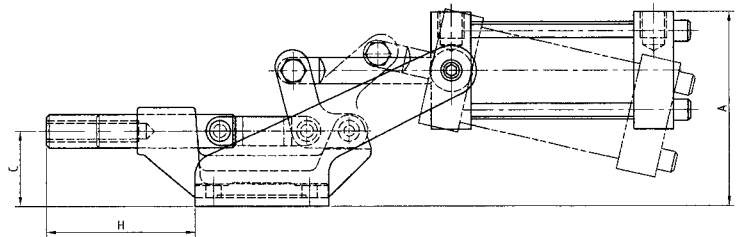
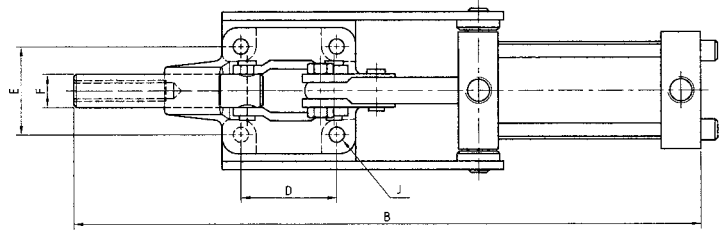

Model	A	B	C	D	E	F	H	J	Holding Capacity	Shipping Weight	Plunger Travel	Plunger Thread	Port Size
AC 100 - SL	73.8	238.4	28.6	36.5	33.5	12.7	56.4	5.8	270 Kg	782 g	19	M8X1.25	1/8 NPT

AC 350-SL

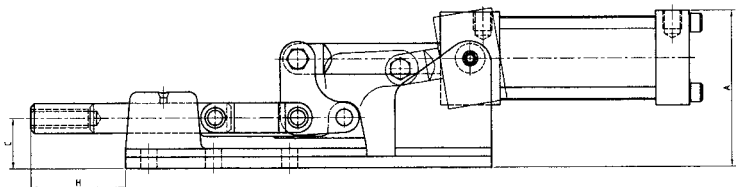
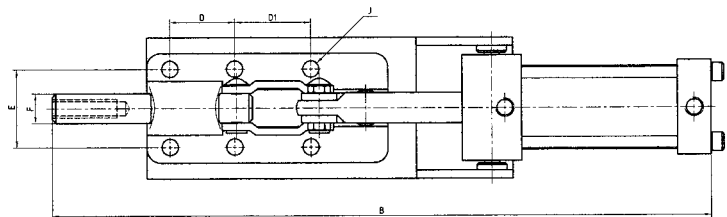

Larger size of straight line action air clamp.
Similar to SL 350 except operated by air
cylinder not by hand.



Model	A	B	C	D	D1	E	F	H	J	Holding Capacity	Shipping Weight	Plunger Travel	Plunger Thread	Port Size
AC 350 - SL	84	354.7	27	35	41	42	16	51	8.8	1100 Kg	2612 g	32	M10X1.5P	1/8 NPT

ACCESSORIES

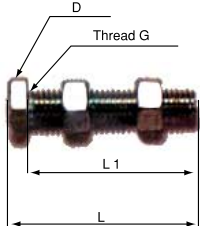
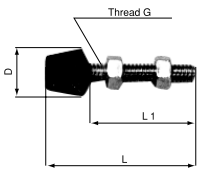
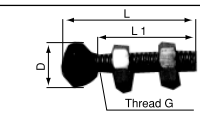
Adjustable Spindle Assemblies

	Part No.	L	L1	D	G	Furnished with
 <p>Hex Head</p>	Nylon :					
	832203	21	18.5	6	M4X0.7P	HH 150, HH 250
	Fully Threaded Carbon Steel :					
	407203	17.5	15	7	M4X0.7P	SL 07
	420125	54	50	10	M6X1.0P	NO.38BS(S), NO.38S(S)
	518136	30	25	12	M8X1.25P	SA 350, NO.51
	518125	35	30	12	M8X1.25P	SA 350, NO.51, SL 251-B
	518203	50	45	12	M8X1.25P	SA 250
	518205	55.6	50.4	12	M8X1.25P	NO.42A, NO.42K, NO.42P, NO.42S
	518207	69.5	65	12	M8X1.25P	"NO.38B(L), NO.38S(L)"
	316125	38.5	31.5	14	M10X1.5P	SA 455-2
	316203	77	70.7	14	M10X1.5P	SA 550
	113203	68	60	19	M12X1.75P	SA 2
	Stainless Steel :					
	832203-2S	23	20	6	M4X0.7P	HH 150-2S, 151-B2S, 250-2S, SL10-2S
508203-2S	28	25	8	M5X0.8P	HH 300-2S, HH 301-B2S,	
420136-2S	44	40	10	M6X1.0P	HH 350-2S, HH 351-B2S, HV 250-2S, HV250-U2S	
518205-2S	55.6	50.4	12	M8X1.25P	HH 500-2S, HH 501-B2S, HH 450-2S, HV 450-2S, HV 300-2S	
420125-2S	54	50	10	M6X1.0P	NO. 38 B(S)-2S, No. 38 S(S)-2S	
 <p>Neoprene Tipped:</p>	407208	21.8	17	8.5	M4X0.7P	SL 10
	508208	34	26	14	M5X0.8P	HH 300, HV 200
	420208	49.6	36	17	M6X1.0P	HV 250, HV 250-U, AC 250, HH 350, HH 350-S, HH 400
	518208	65.5	48.4	19	M8X1.25P	HH 450, HH 500, HV 350, HV 450, NO.82, NO.82-S, SF 350, UF 450, AC 350, AC 353-L, AC 450, AC 453-L
	316208	83.6	60	23	M10X1.5P	HH 550, HV 550, HV 650, AC 550, AC 650, HH 600
	825208	44	35	16.8	M8X1.25P	HV 300
	105208	67	54	22	M10X1.5P	HV 400
	 <p>Vinyl Coated:</p>	832208	30	23	8.5	M4X0.7P
430208		35	28.4	14	M6X1.0P	SA 150
431208		31	22	14	M6X1.0P	SA 155-2
 <p>Swivel Foot:</p>	316206	77.6	65.6	16	M10X1.5P	SA 450, SA 550

Flanged Washers

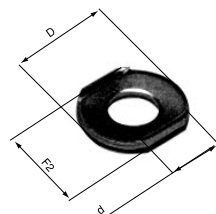
	Part No.	D	d	F2	For Spindle	Furnished with	
	832106	11.4	4.4	9.2	M4	HH 250	
	832111	14.3	4.3	9.2	M4	HV 150	
	508107	14.5	5.3	11	M5	HV 200, HH 300	
	420105	18.2	7	12.2	M6	HH 350, HH 400, HH 401-B	
	420111	17.5	6.7	13	M6	HV 250-U, AC 250	
	420106	21	6.4	15.4	M6	NO.38B(S), NO.38S(S)	
	518107	22.2	8.3	15.9	M8	HH 450, HH 500, HV 450, NO.82, UF 450, AC 450, AC 453-L, HV 300	
	518111	25.4	8.5	19.8	M8	NO.38B(L), NO.38S(L)	
	316106	26	10.4	21	M10	HH 550, HV 650, AC 650, HH 600, HV 400	
	113106	32	14	23.5	M12	HV 850, HV 851-B	
	511106	37	17.2	28.4	M16	HV 1050, HV 1051-B	
	518105	16.2	8.3	17.5	M8	NO.42A, NO.42K, NO.42P, NO.42S	
	Stainless Steel:						
	832106-2S	11.4	4.4	9.2	M4	HH 250-2S, HH 251-B2S	
	832111-2S	14.3	4.3	9.2	M4	HV 150-2S, HV 151-B2S	
508107-2S	14.5	5.3	11	M5	HH 300-2S, HH 301-B2S, HV 200-2S		
420105-2S	18.2	7	12.2	M6	HH 350-2S, HH 351-B2S, HH 400-2S, HH 401-B2S		
518107-2S	22.2	8.3	15.9	M8	HH 500-2S, HH 501-B2S, HV 450-2S, HH 450-2S, HV 300-2S		
518105-2S	16.2	8.3	17.5	M8	NO.42A-2S, NO.42K-2S		
420111-2S	17.5	6.7	13	M6	HV 250 U-2S		
420106-2S	21	6.4	15.4	M6	NO. 38 B (S)-2S, No. 38 S(S)-2S		

Bolt Retainers

	Part No.	A	B	F1	D	For Spindle	Furnished with
	420000	32	12.7	4	7.1	M6	HH 350-S, HH 350-SB
	518000	33	15.9	6.4	8.3	M8	HV 350, NO.82-S, SF 350
	316000	47	19	8.2	13.5	M10	HV 550, AC 550
	113000	38.3	22.2	9	14.2	M12	HV 750, HV 751-B
	511000	43.8	31.75	9.2	16.2	M16	HV 950, HV 951-B

CROSS REFERENCE

KAKUTA	DESTACO	AMF	BRAUER	NLM	SPEEDY BLOCK
HH 150	205-S	-	H50/2C	-	-
HH 150-2S	205-SSS	-	-	-	-
HH 151-B	205-SB	-	-	-	-
HH 151-B2S	205-SBSS	-	-	-	-
HH 154-LE	205-SL	-	-	-	-
HH 155-R	205-SR	-	-	-	-
HH 250	205-U	93005	H50/2B	-	-
HH 250-2S	205-USS	95141	H50/2BSS	-	-
HH 251-B	205-UB	93203	H50/1B	-	-
HH 251-B2S	205-UBSS	-	-	-	-
HH 254-LE	205-UL	-	H50/2BL	-	-
HH 255-R	205-UR	-	H50/2BR	-	-
HH 300	213-U	93013	H75/2B	-	70/M
HH 300-2S	213-USS	95166	H75/2BSS	-	-
HH 301-B	213-UB	93211	-	-	70/N
HH 301-B2S	-	-	-	-	-
HH 350	215-U	-	-	-	-
HH 350-2S	215-USS	-	-	-	-
HH 351-B	215-UB	-	-	-	-
HH 351-B2S	215-UBSS	-	-	-	-
HH 350-S	215-S	-	-	-	-
HH 351-SB	215-SB	-	-	-	-
HH 400	217-U	93021	H150/2B	512060	115/M
HH 400-2S	217-USS	95182	H150/2BSS	-	-
HH 401-B	217-UB	93229	H150/1B	-	115/N
HH 401-B2S	-	-	-	-	-
HH 450	225-U	-	-	-	-
HH 450-2S	225-USS	-	-	-	-
HH 451-B	225-UB	-	-	-	-
HH 451-B2S	225-UBSS	-	-	-	-
HH 500	227-U	93039	H250/2B	512080	220/M
HH 500-2S	227-USS	95208	-	-	-
HH 501-B	227-UB	93237	H250/1B	-	-
HH 501-B2S	-	-	-	-	-
HH 550	235-U	93054	H350/2B	-	-
HH 551-B	-	93252	-	-	-
HH 551-BN	235-UB	-	H350/1B	-	-
HH 600	237-U	93047	H450/2B	512100	350/M
HH 601-B	237-UB	93245	H450/1B	-	350/N
HV 150	201-U	90019	V75/2B	502050	70/A
HV 150-2S	221-USS	95026	V75/2BTSS	-	70/AX
HV 151-B	201-UB	90217	V75/1B	-	70/B
HV 151-B2S	201-UBSS	-	-	-	70/BX
HV 151-BT	201-TUB	-	-	-	-
HV 152-T	201-TU	-	-	-	-
HV 153-XL	-	-	-	-	-
HV 200	305-U	-	V70/2BT	-	-
HV 200-2S	305-USS	-	V70/2BTSS	-	-
HV 250	202	90514	V150/2C	-	-
HV 250-2S	202-SS	-	-	-	-
HV 251-B	202-B	-	V150/1C	-	-
HV 251-B2S	202-BSS	-	-	-	-
HV 251-BT	202-TB	-	-	-	-
HV 252-T	202-T	-	-	-	-
HV 250-U	202-U	90027	V150/2B	502060	-
HV 250-U2S	202-USS	95042	V150/2BSS	-	-
HV 251-UB	202-UB	90225	V150/1B	-	-
HV 251-UBT	202-TUB	-	-	-	-
HV 252-UT	202-TU	-	-	-	-
HV 253-UL	202-UL	-	V150/2BL	-	-
HV 253-UL2S	-	-	-	-	-
HV 300	307-U	-	-	-	-
HV 300-2S	307-USS	-	-	-	-
HV 350	207-S	90431	V250/2A	502081	200/E
HV 351-B	207-SB	90555	V250/1A	-	200/F
HV 351-BT	207-TSB	-	-	-	-
HV 351-BL	207-LB	-	V250/1AS	-	-
HV 351-BTL	207-TLB	-	-	-	-
HV 352-T	207-TS	-	-	-	-
HV 352-TL	207-TL	-	-	-	-
HV 353-L	207-L	-	V250/2AS	-	-
HV 400	309-U	-	-	-	-
HV 400-2S	309-USS	-	-	-	-
HV 450	207-U	90035	V250/2B	502080	200/A
HV 450-2S	207-USS	95067	V250/2BSS	-	-
HV 451-B	207-UB	90233	V250/1B	-	200/B
HV 451-B2S	207-UBSS	-	-	-	-
HV 451-BT	207-TUB	-	-	-	-
HV 451-BL	207-ULB	-	-	-	-
HV 451-BTL	207-TULB	-	-	-	-
HV 452-T	207-TU	-	-	-	-
HV 452-TL	207-TUL	-	-	-	-
HV 453-L	207-UL	-	-	-	-
HV 453-XL	-	-	-	-	-
HV 550	201-S	90449	V350/2A	-	300/E
HV 551-B	210-SB	90563	V350/1A	-	300/F
HV 551-BT	210-TSB	-	-	-	-
HV 552-T	201-TS	-	-	-	-
HV 650	210-U	90043	V350/2B	-	300/A
HV 651-B	210-UB	90241	V350/1B	-	300/B
HV 651-BT	210-TUB	-	-	-	-
HV 652-T	210-TU	-	-	-	-
HV 750	247-S	90456	V450/2A	502121	400/E
HV 751-B	247-SB	-	V450/1A	-	400/F
HV 850	247-U	90050	V450/2B	502120	400/A
HV 851-B	247-UB	-	V450/1B	-	400/B
HV 950	267-S	90464	V550/2A	-	500/E
HV 951-B	267-SB	-	V550/1A	-	500/F
HV 1050	267-U	90068	V550/2B	-	500/A
HV 1051-B	267-UB	-	V550/1B	-	500/B
SF 350	207-SF	-	-	-	-
UF 450	207-UF	-	-	-	-

CROSS REFERENCE

KAKUTA	DESTACO	AMF	BRAUER	NLM	SPEEDY BLOCK
No. 82	317-U	-	-	-	200/AV
No. 82-S	317-S	-	-	-	200/EV
No. 38B(S)	-	-	-	-	-
No. 38S(S)	-	-	-	-	-
No. 38B(L)	-	-	-	-	-
No. 38S(L)	-	-	-	-	-
No. 42A	-	-	-	-	-
No. 42A-2S	-	-	-	-	-
No. 42K	-	-	-	-	-
No. 42K-2S	-	-	-	-	-
No. 42P	-	-	-	-	-
No. 42S	-	-	-	-	-
PA 150	301	-	-	-	200/TF
PA 170	311	-	-	-	200/T
PA 250	351	94540	LH 400	508001	-
PA 250-2S	351-SS	95422	LH 400SS	-	-
PA 251-B	351-B	94680	-	-	-
PA 251-B2S	351-BSS	95455	-	-	-
PA 270	371	-	LH700	-	300/T
PA 350	381	-	-	-	400/T
FA 100	323	-	-	-	160/T2
FA 100-2S	323-MSS	-	-	-	160/T2X
FA 102	-	94698	LU 200H	-	-
FA 102-2S	-	95521	LU 200HSS	-	-
FA 130	324	-	-	-	160/T3
FA 130-2S	324-SS	-	-	-	160/T3X
FA 140	-	94755	-	-	-
FA 140-2S	-	95588	-	-	-
FA 200	331	-	-	-	320/T2
FA 200-2S	331-SS	-	-	-	320/T2X
FA 202	-	94706	LU 400H	-	-
FA 202-2S	-	95547	LU 400HSS	-	-
FA 230	334	-	-	-	320/T3
FA 230-2S	334-SS	-	-	-	320/T3X
FA 240	-	94763	-	-	-
FA 240-2S	-	95604	-	-	-
FA 300	341	-	-	-	700/T2
FA 300-2S	341-SS	-	-	-	700/T2X
FA 302	-	94714	LU 700H	-	-
FA 330	344	-	-	-	700/T3
FA 340	-	94771	-	-	-
FA 600	375	-	-	-	-
FA 601-B	375-B	-	-	-	-
FA 700	385	93856	-	-	2800/T2
SL 07	-	-	-	-	-
SL 10	601	-	-	-	-
SL 10-2S	601-SS	-	-	-	-
SL 15-2	601-O	-	-	-	-
SL 15-22S	601-OSS	-	-	-	-
SL 70	-	-	-	-	-
SL 70-2S	-	-	-	-	-
SL 70-RR	-	-	-	-	-
SL 70-LR	-	-	-	-	-
SL 100	-	-	-	-	-
SL 105-2	603	-	-	-	360/AS
SL 105-22S	-	-	-	-	-
SL 110	609	-	-	-	-
SL 111-B	609-B	-	-	-	-
SL 300	-	-	-	-	-
SL 150	605	-	-	-	-
SL 160	615	-	-	-	-
SL 200	-	-	-	-	-
SL 210	608	-	-	-	-
SL 240	620	-	-	-	-
SL 241-B	628	-	-	-	-
SL 250	610	-	-	-	-
SL 251-B	618	-	-	-	-
SL 300	-	-	-	-	-
SL 310	607	-	-	-	550/AS
SL 350	630	-	-	519200	1100/AS
SL 450	640	-	-	-	-
No. 02	-	-	-	-	-
No. 51	-	-	-	-	-
FM 50	602	94300	P100	517010	-
FM 50-2S	602-SS	95349	P100SS	-	-
FM 150	604	94318	P200	517012	-
FM 150-2S	604-SS	95364	P200SS	-	-
FM 150-1	-	-	-	-	150/AS
FM 250	624	94334	P400	517016	-
SA 2	325	-	TC79	-	-
SA 150	424	-	PO	-	-
SA 155-2	424-2	-	-	-	-
SA 250	441	-	P1A	-	-
SA 255-2	441-2	-	-	-	-
SA 350	461	-	-	-	-
SA 450	462	-	P1B	-	-
SA 455-2	462-2	-	-	-	-
SA 550	463	-	P3B	-	-
V. 1	-	-	-	-	-
V. 1-SB	-	-	-	-	-
V. 2	-	-	-	-	-
V. 2-SB	-	-	-	-	-
V. 3	-	-	-	-	-
V. 1X	501-MB	90738	V300/S	-	-
V. 1X-B	501-MLB	90803	V300/T	-	-
V. 2X	503-MB	90746	V700S	542002	-
V. 2X-B	503-MLB	90811	V700T	544002	-
V. 3X	505-MB	90753	VA1200S	542004	-
V. 3X-B	505-MLB	90829	VA1200T	544004	-
AC 250	802	91975	V150X	-	-
AC 350	807-L	-	-	-	200/EP3
AC 353-L	-	-	V250X	-	-
AC 450	807-UL	-	-	-	-
AC 453-L	-	91983	-	-	-
AC 550	810-S	-	-	-	300/EP3
AC 650	810-U	91991	V450X	-	300/AP3
AC 100-SL	803	-	-	-	360/SP3
AC 350-SL	830	-	-	-	1100/SP3

Kakuta Kogyo Co., Ltd

1-28-5, Ohi Shinagawa-ku,
TOKYO, 140 JAPAN
Tel: (813) 3774-7001 Fax: (813) 3774-7086

Kakuta USA Inc.

390 Swift Avenue, Unit 23
South San Francisco, CA. 94080
United States of America
Tel: 1 (650) 589-2929 Fax: 1 (650) 589-5959
www: kakutaus.com

Kakuta Europe GmbH

Luisen Str. 9,
90762 Furth
Germany
Tel. 49 (0) 911 787 5391 Fax: 49 (0) 911 787 5392
www: kakutaco.com

Thai Kakuta Co., Ltd.

219 Lat Krabang Industrial Estate.
Chalongkrung Road, A. Lat Krabang,
Bangkok 10520, THAILAND.
Tel: (662) 326-0421 Fax: (662) 326-0271
www: kakutaco.com



KAKUTA KOGYO COMPANY LIMITED

Kakuta Kogyo Co., Ltd

1-28-5, Ohi Shinagawa-ku,
TOKYO, 140 JAPAN
Tel: (813) 3774-7001 Fax: (813) 3774-7086

Kakuta USA Inc.

390 Swift Avenue, Unit 23
South San Francisco, CA. 94080
United States of America
Tel: 1 (650) 589-2929 Fax: 1 (650) 589-5959
www: kakutaus.com

Kakuta Europe GmbH

Luisen Str. 9,
90762 Furth
Germany
Tel. 49 (0) 911 787 5391 Fax: 49 (0) 911 787 5392
www: kakutaco.com

Thai Kakuta Co., Ltd.

219 Lat Krabang Industrial Estate.
Chalongkrung Road, A. Lat Krabang,
Bangkok 10520, THAILAND.
Tel: (662) 326-0421 Fax: (662) 326-0271
www: kakutaco.com



KAKUTA KOGYO COMPANY LIMITED